

Assembly Instructions 2750D Inspection Stand

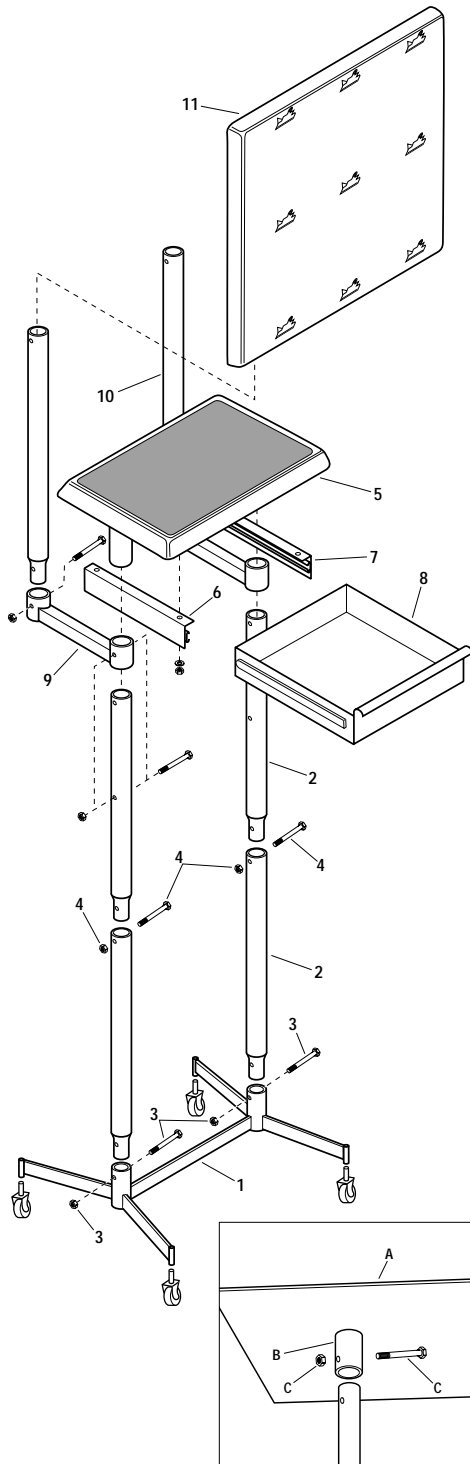

-Detail 1-
Assembling inspection
panel to posts.

NOTE: This stand may be assembled with writing surface (item 5) at a height suitable for either standing use or seated use. To assemble for seated use, substitute 11" long post section for 22 1/2" long section (item 2).

Refer to illustration at left. *NOTE: The unit you are assembling may look slightly different than the illustration.*

1. Identify posts for stand (item 2).
2. Slide end of lower post (2) into base (1). Secure with screw and nut (3). Tighten. Slide upper post into top of lower post. Secure with screw and nut (4). Tighten.
3. Install casters.
4. Slip mounting arms (9) onto ends of stand posts. Secure with screw and nut. Tighten.
5. Remove the four 1/4" - 20 nuts from plate on underside of 20" x 26" inspection panel (5). Mount drawer adapters (6 & 7) to plate and replace nuts.
NOTE: Mounting flanges of adapters must be facing each other.
6. Slide inspection panel (5) onto top of stand posts (detail 1). Secure with screw and nut. Tighten (C on detail 1).
7. Slip tubes (10) into mounting arms (9). Secure with screw and nut. Tighten.
8. Slip mounting sleeves on back of display panel (11) onto tops of tubes. Secure with screw and nut. Tighten.
9. Slide drawer (8) into glide mechanisms on drawer adapters (6 & 7).
NOTE: make sure ball bearings are fully engaged and not cocked or drawer will not stay in grooves.
10. Install neoprene pad on inspection panel.



Workplace Solutions

Gleason Reel Corp.

P.O. Box 26 • 600 South Clark St.

Mayville, WI 53050

Phone: 920-387-4120 • Fax: 920-387-4189

www.gleasonreel.com

Part No. 2694.b