

ATTACHING PEG BOARD TO WORKSTATIONS; HERE'S TWO SIMPLE WAYS...

#WS-UH UNIVERSAL BRACKETS were designed with peg board in mind. Peg board may be bolted to front of brackets (below, left) or behind tabs (below right). Either way, slots in brackets fit holes in peg board for bolting.

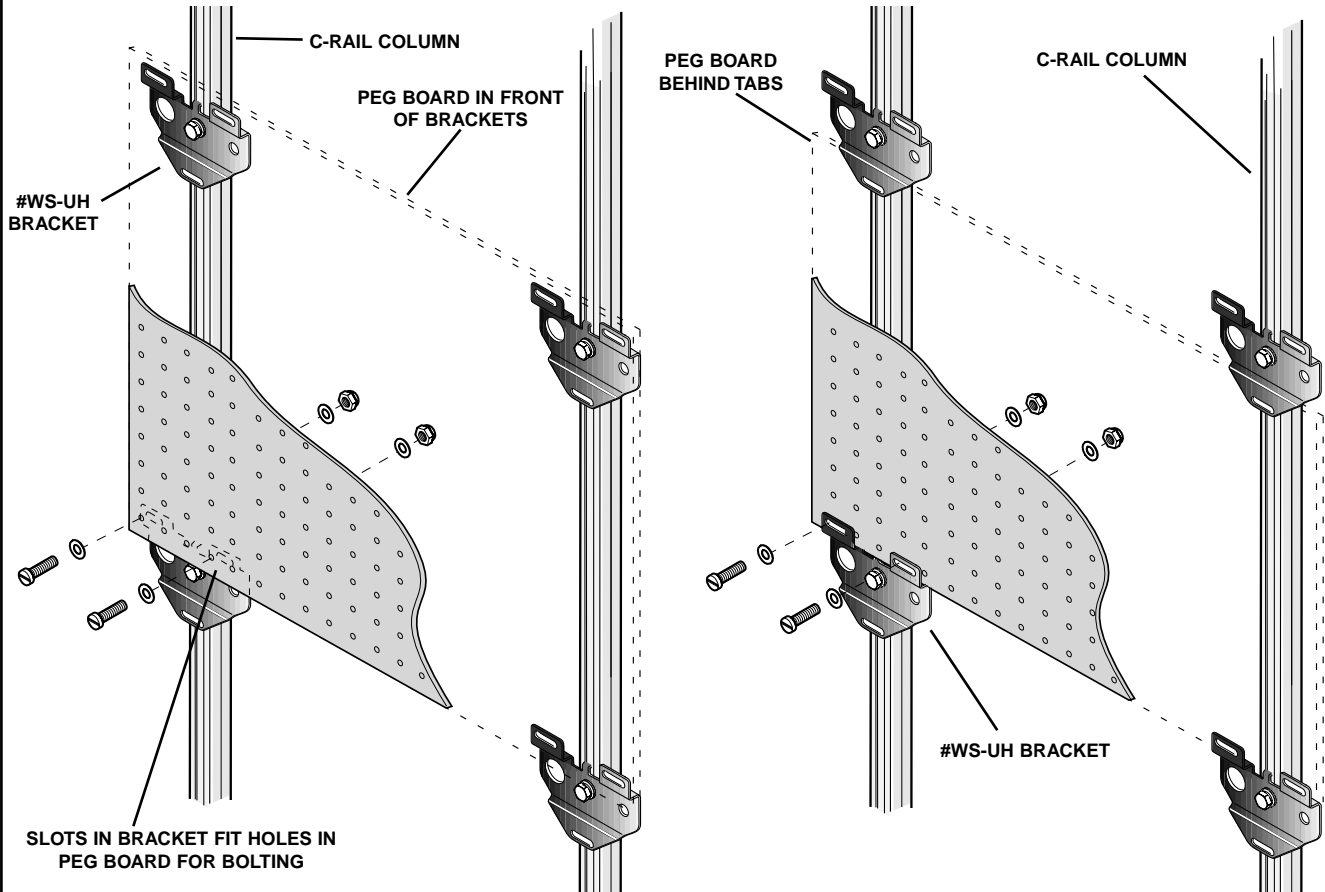

METHOD OF ATTACHING BRACKETS TO COLUMNS

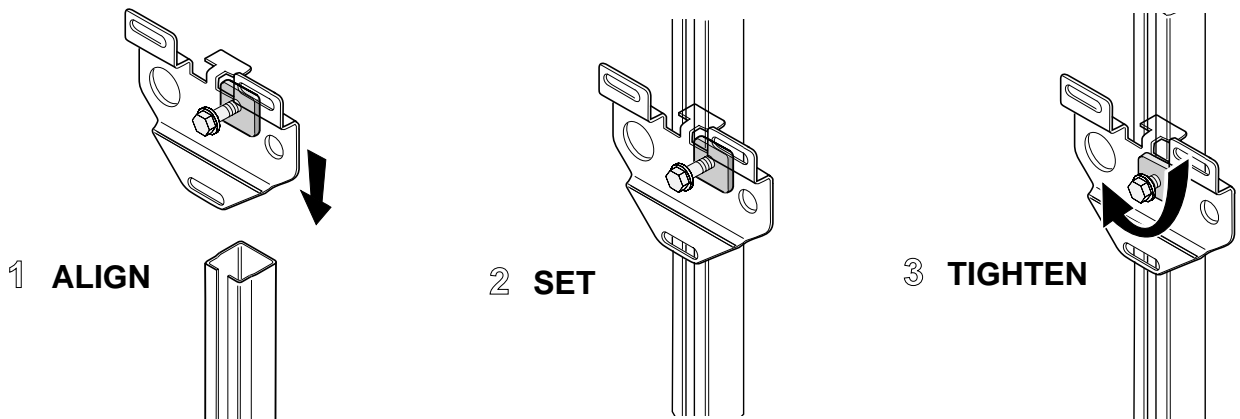

MORE →

ATTACHING PEG BOARD TO WORKSTATIONS; HERE'S EVEN ANOTHER WAY...

For added stiffness on wider workstations, use **#WS50-BB0x** BIN BARS top and bottom. Peg board is bolted to back. Four inch on center slots in bin bars fit holes in peg board. Use flat washers both sides.

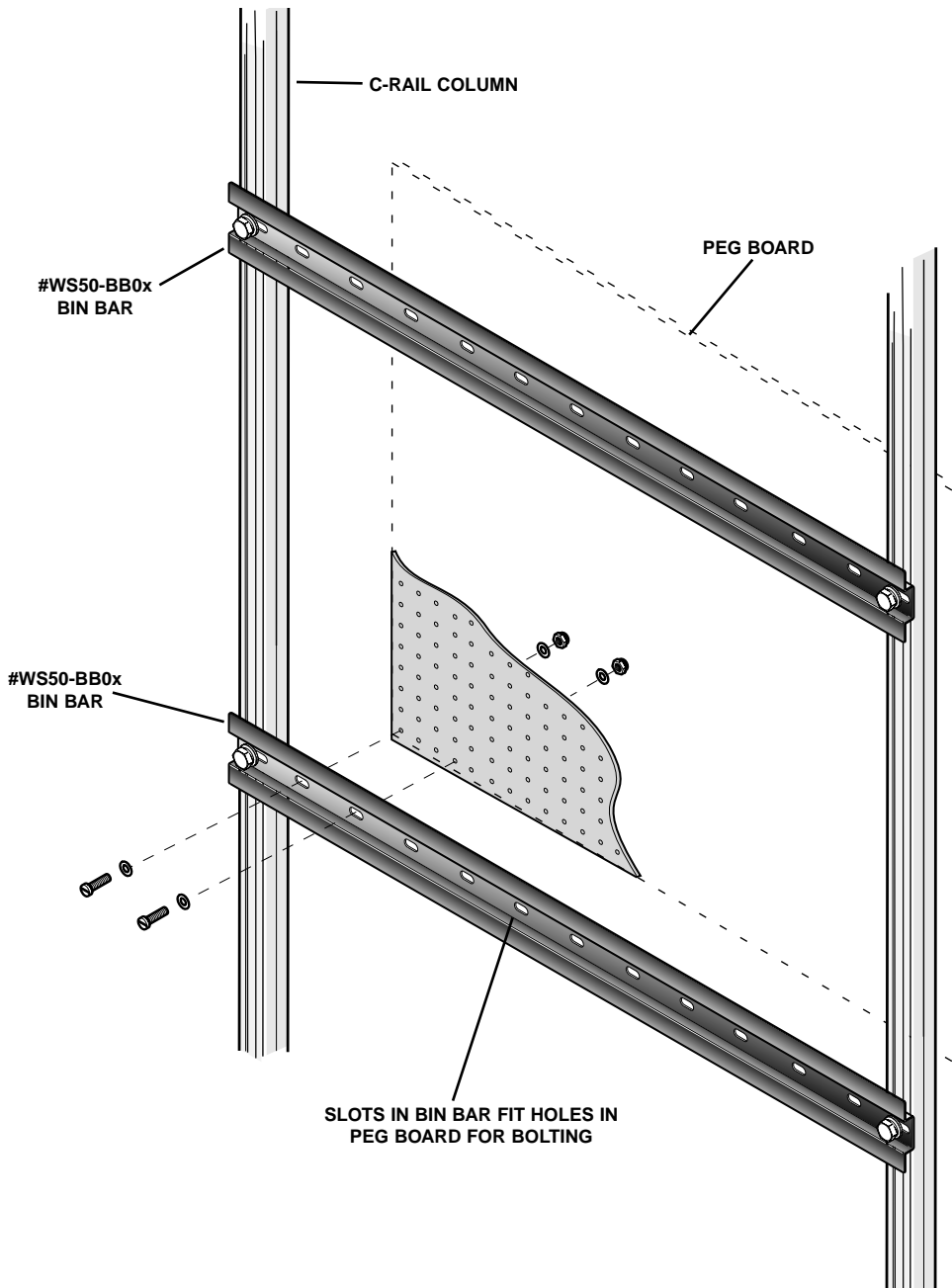

Workplace Solutions

P.O. Box 25 • 600 South Clark St. • Mayville, WI 53050-0026 • Phone 920-387-5195