

TORQ-ARM for Trolley Mounting

INSTALLATION and ADJUSTMENT

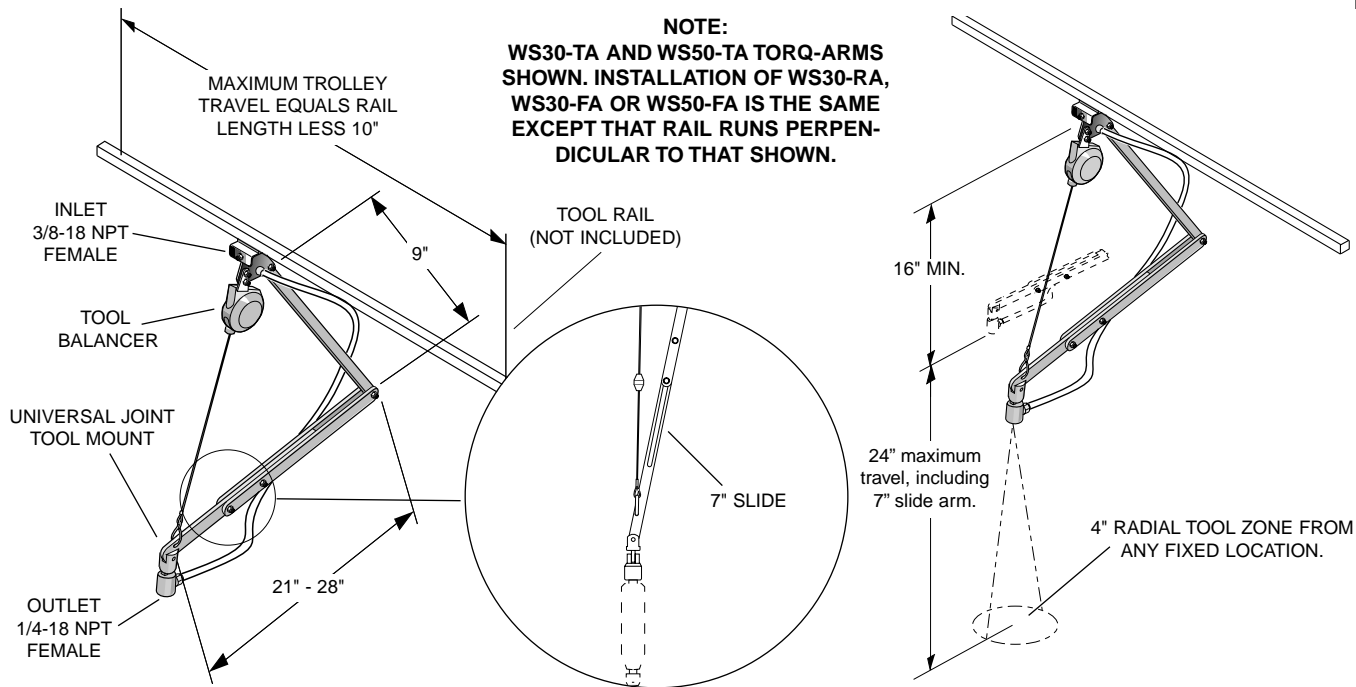

INSTALLATION

- 1- Slide trolley into rail. **NOTE:** WS30-xx TORQ-ARMS go into WS30 rails. WS50-xx TORQ-ARMS go into WS50 rails.
- 2- Install end stop and end cap into rail. Securely tighten bolts clamping end stop to rail.

WARNING

Improperly tightened end stop bolts could result in damage to equipment or personal injury.

- 3- Install tool onto TORQ-ARM and connect air line.
- 4- Adjust tool balancer for desired action.

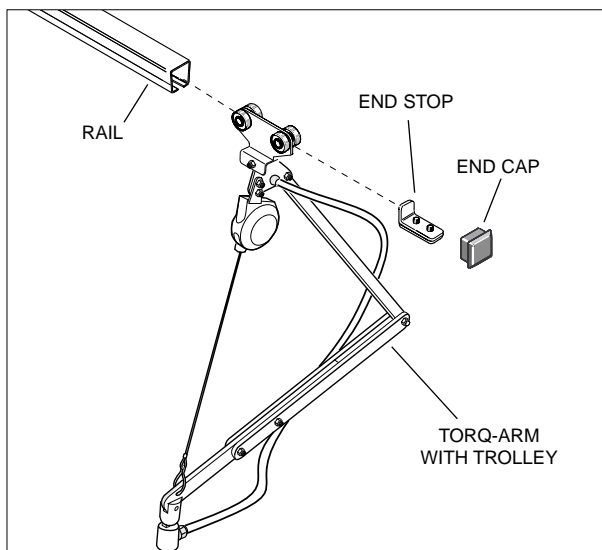

ADJUSTING BALANCER

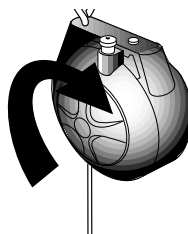

- 1- Increase tension by turning adjustment knob clockwise.



- 2- Decrease tension by pushing button on top of balancer. One click equals 1/5 turn of adjustment knob.

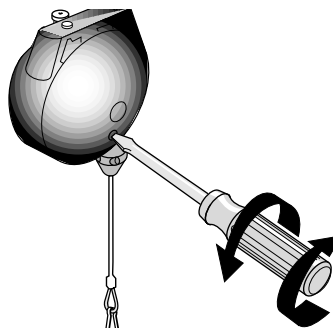

- 3- Adjust drag so that tool remains in desired "hands off" position. Increase drag by turning screwdriver clockwise. Decrease drag by turning screwdriver counterclockwise.

