

Cable and Hose Management

Since 1911, Gleason Reel Corp. has been in the business of cable and hose management. Our products are designed to convey and protect valuable cables and hoses that power and control moving machines of all types. They improve productivity and safety on the job by moving cables and hoses away from hazardous locations on machinery or the shop floor into a controlled environment. Whether you choose Reels for efficient storage and payout from virtually any angle, Festoon Systems for overhead applications or PowerTrak® for protection on machinery in motion, your cables and/or hoses will last longer and provide better service with a cable management system from **Gleason Reel Corp...**

...The Cable & Hose Management Company!



In addition to the hose reels shown in this bulletin be sure to look for Gleason cable and cord reels, festoon systems, Gleason PowerTrak cable and hose carriers, slip ring assemblies, Hubbell Workplace Solutions workstation kits and components, tool balancers and rotary limit switches.



Gleason Reel Corp.
600 South Clark St. • P.O. Box 26
Mayville, WI 53050
Phone: 920-387-4120 • Fax: 920-387-4189
www.hubbell-gleason.com

INSTALLATION and MAINTENANCE INSTRUCTIONS UH60/62 Dual Oxygen/Acetylene Hose Reel

All units are provided with right hand rotation unless otherwise specified. This means that hose is pulled off spool top left or bottom right (spool rotates clockwise to wind hose) when viewing spring end of reel.

Clock-type springs provide power for automatic hose take-up. Spring must be pretensioned at time of installation to insure that tension is applied to hose at all times.

⚠ WARNING

Do not attempt to remove spring from its housing. Clock-type springs can be dangerous to handle. Removal of spring from housing could result in personal injury.

The unique SAFETYCHANGE® spring motor consists of a spring and hub sealed within a housing. A replacement spring is supplied sealed in its housing and the old unit should be discarded completely.

INSTALLATION

1. Install hose if reel was purchased without hose. See instructions on page 4.
2. Securely mount reel in desired position using 1/2"(M12). Be sure spool is aligned with hose run.
3. Position hose guide if supplied so hose pays-out as straight as possible through hose guide.
4. Connect free end of hose to connections on machine or adjust hose stop so that desired length of hose extends from reel.
5. Connect flexible supply lines to swivel fitting. See HOSE INSTALLATION REFERENCE DRAWING. **NOTE: Do not hard plumb to swivel fitting.**

⚠ CAUTION

Do not exceed number of turns indicated on serial plate. Over-tensioning can cause a broken spring, sheared shaft or other damage.

SPRING REPLACEMENT

1. Turn off supply pressure to reel.
2. Wind all hose onto reel to relieve all spring tension.
3. Disconnect supply line to swivel fitting on spring side.
4. Remove swivel fitting from spring stub shaft.
5. Remove inspection cover from face of spring housing.
6. Rotate spool clockwise and observe inner shaft. Shaft should rotate clockwise and hub (with spring attached) should remain stationary.
7. Remove (4) bolts which secure spring motor to frame.
8. Slide spring motor off shaft and discard.

NOTE: Do not attempt to remove spring if resistance is met or hub tends to rotate with shaft. Continue to rotate spool and strike end of shaft several sharp blows with a lead hammer or rubber mallet until shaft rotates freely and hub remains stationary.

NOTE: Pawl springs must be located between the pawls and the deepest section of the shaft grooves. Make sure that pawls and pawl springs are inserted flush with ends of shaft and hub or they may rub against inspection cover. See Fig 4, page 4.

MAINTENANCE

Periodically: A. Inspect hose for wear and check mounting bolts and other hardware for tightness.

B. Check for broken springs by pulling about 2/3 hose off reel and observing "Broken Spring Indicators" on sides of spring canisters (Fig. 3).

NOTE: Bearings and springs are prelubricated and require no periodic maintenance.

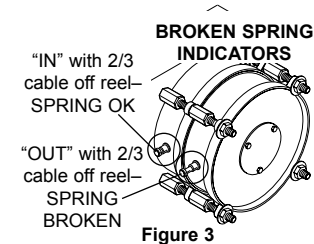

Figure 3

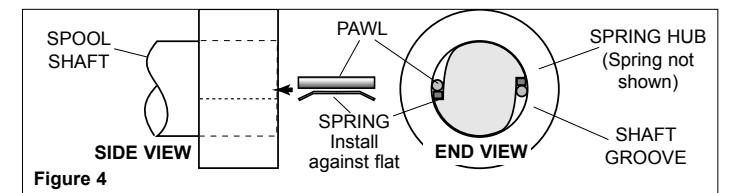

Figure 4

9. Tighten bolts securing spring housing to reel frame.
10. Connect free end of hose to connections on machine or adjust hose stop so that desired length of hose extends from reel.

DIRECT DRIVE UH60/62 DUAL OXY/ACET. HOSE REEL REPLACEMENT PARTS LIST

ITEM	PART NO.	DESCRIPTION	QTY.
1	042018	Vertical Frame Assy., Swivel Side	1
2	012140	Housing, 2" Bore Bearing	2
3	103837	Ball Bearing, 2" Bore	1
4	038424	Flat Washer, M8	9
5	028268	ESNA Lock Nut, M8-1.25	8
6	042008	Vertical Frame Assy., Drive Side	1
7	119114	Housing, 1.75" Bore Bearing	2
8	103823	Ball Bearing, 1.75" Bore	1
9	045305	Spool Support Hub, Drive Side	1
10	-		-
11	111538	Retaining Ring	1
12	042028	Spool Disk, U28	2
13	05378903	Wrapper Segment - 4.50"	7
14	040244	Screw M8 - 1.25 x 20mm lg.	36
15	055325	Spool Hub - Swivel Side	1
16	028131	Screw M10 - 1.5 x 20mm lg.	8
17	028138	Lockwasher, M10	8
18	045306	Stub Shaft Drive Plate	1
19	04205710	Bottom Base - 4.50" Wrapper	1
20	055323	Stub Shaft #60 Spring	1
20	055324	Stub Shaft #62 Spring	1
21	012425	Pawl Kit (60 Spring)	AR
21	012426	Pawl Kit (62 Spring)	AR

ITEM	PART NO.	DESCRIPTION	QTY.
22	031484	Hex Hd. Cap Screw, M12-1.75 x 35L	4
23	025942	Lockwasher, M12	4
24	025941	Hex Nut, M12-1.75	4
25	042555	Stand-off, 60 Springs	AR
25	042183	Stand-off, 62 Springs	AR
26	029159	Flat Washer, M12	4
27	028502	ESNA Nut, M12-1.75	4
28	055334	Spring Motor Kit, 60, Standard Rotation (Includes items 21, 29, 30, & 31)	1
28	055335	Spring Motor Kit, 62, Standard Rotation (Includes items 21, 29, 30, & 31)	1
29	G51-23	Gasket, Hub Cover	1
30	045310	Hub Cover, Springs	1
31	101220	Screw, #8-32 x 0.25" Lg.	3
32	042078	Hose Stop Bracket - Swivel Side	1
33	055330	Hose Stop Bracket - Spring Side #60	1
33	055331	Hose Stop Bracket - Spring Side #62	1
34	101557	Street Elbow 3/8	4
35	055336	Swivel Joint Assy, 3/8, Oxygen	1
36	055337	Swivel Joint Assy, 3/8, Acetylene	1
37	101441	Adapter, R.H. Thread, Oxygen	2
38	101442	Adapter, L.H. Thread, Acetylene	2
39	055327	Roller Guide Assy	1
40	042230	Dog & Ratchet Assy	1

**Always specify
SERIAL NUMBER & MODEL NUMBER
when ordering parts.**

Item 39 - 055327 - Roller Guide Assy not shown
Item 40 - 042230 - Dog & Ratchet Assy not shown

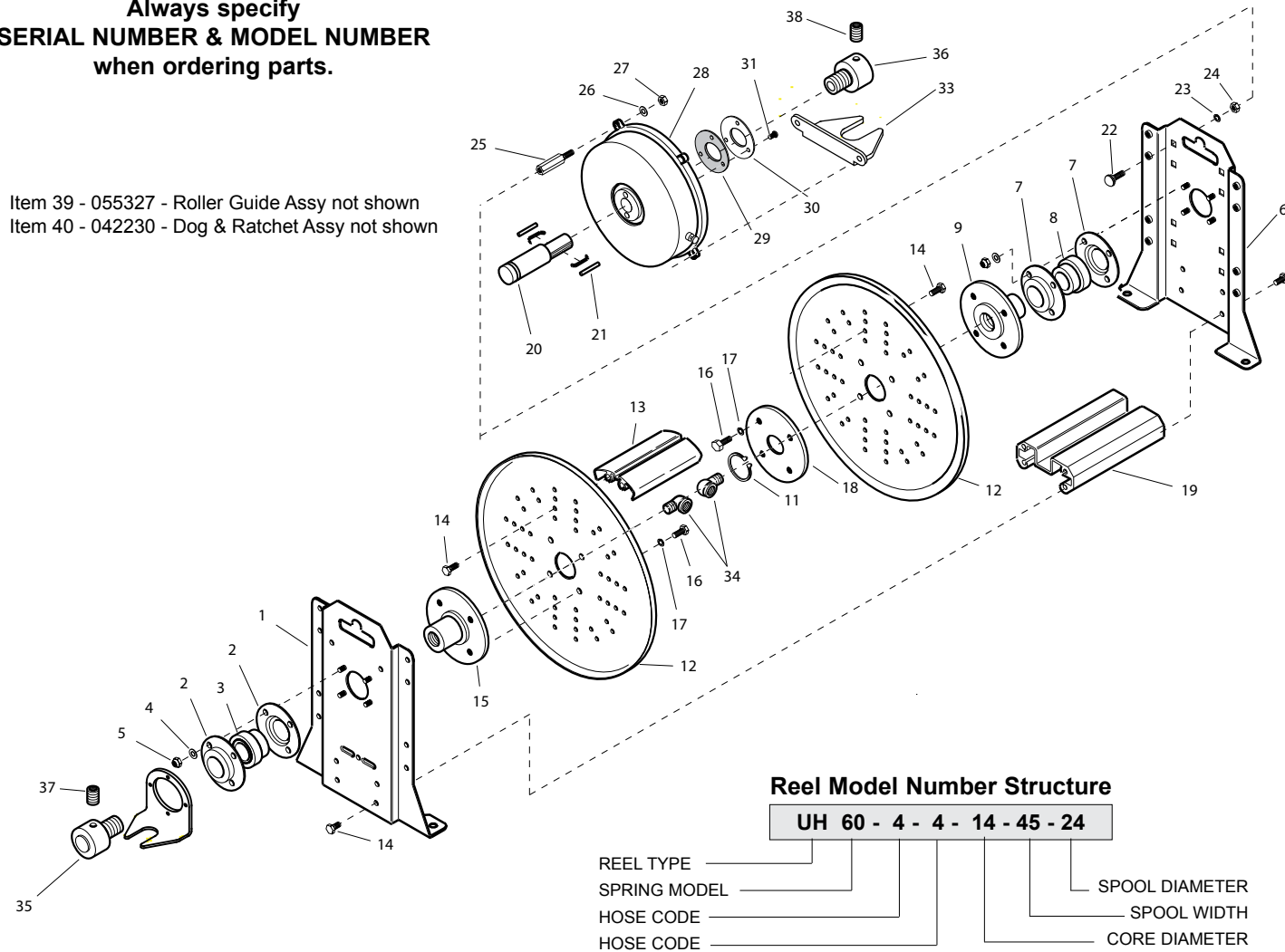

HOSE REMOVAL

Use the following procedure to remove worn or damaged hose from reel prior to installation of new hose.

1. Turn off supply pressure to reel.
2. Disconnect hose from machine or other attachments. Remove hose stop, if installed, and allow hose to retract onto spool. Ensure all tension is off spring by manually rotating spool (normally clockwise when viewed from spring side).
3. Unwrap hose without allowing spool to turn.
4. Disconnect hose from elbows inside spool wrapper.
5. Install new hose following directions below.

HOSE INSTALLATION

Use the following procedure to replace hose or if reel was ordered without hose. Refer to HOSE INSTALLATION REFERENCE DRAWING, below.

1. Unspool new hose from shipping spool and lay out to eliminate twist. NOTE: This step is not essential, but will aid in winding operation of the reel and prolong hose life.
2. Insert hose end through guide and connect to elbows inside spool wrapper. (See drawing below.)
3. Wind the hose onto the reel spool by hand rotating spool in direction it turns free of spring tension. (Normally clockwise when viewed from spring side)
4. Once the hose is wound tight on the spool, turn the spool with the hose (1) turn counter-clockwise for (1) pre-turn. Then feed hose through hose guide and attach hose stop with desired amount of hose extending from reel.
5. Adjust hose stop.
6. Complete working end connections.

HOSE INSTALLATION REFERENCE DRAWING

