



**Gleason Reel Corp.**

P.O. Box 26 • 600 S.Clark St.  
 Mayville, WI 53050  
 Phone: 920-387-4120  
 Fax: 920-387-4189

**BULLETIN NO. CRSHO**

APRIL 1994

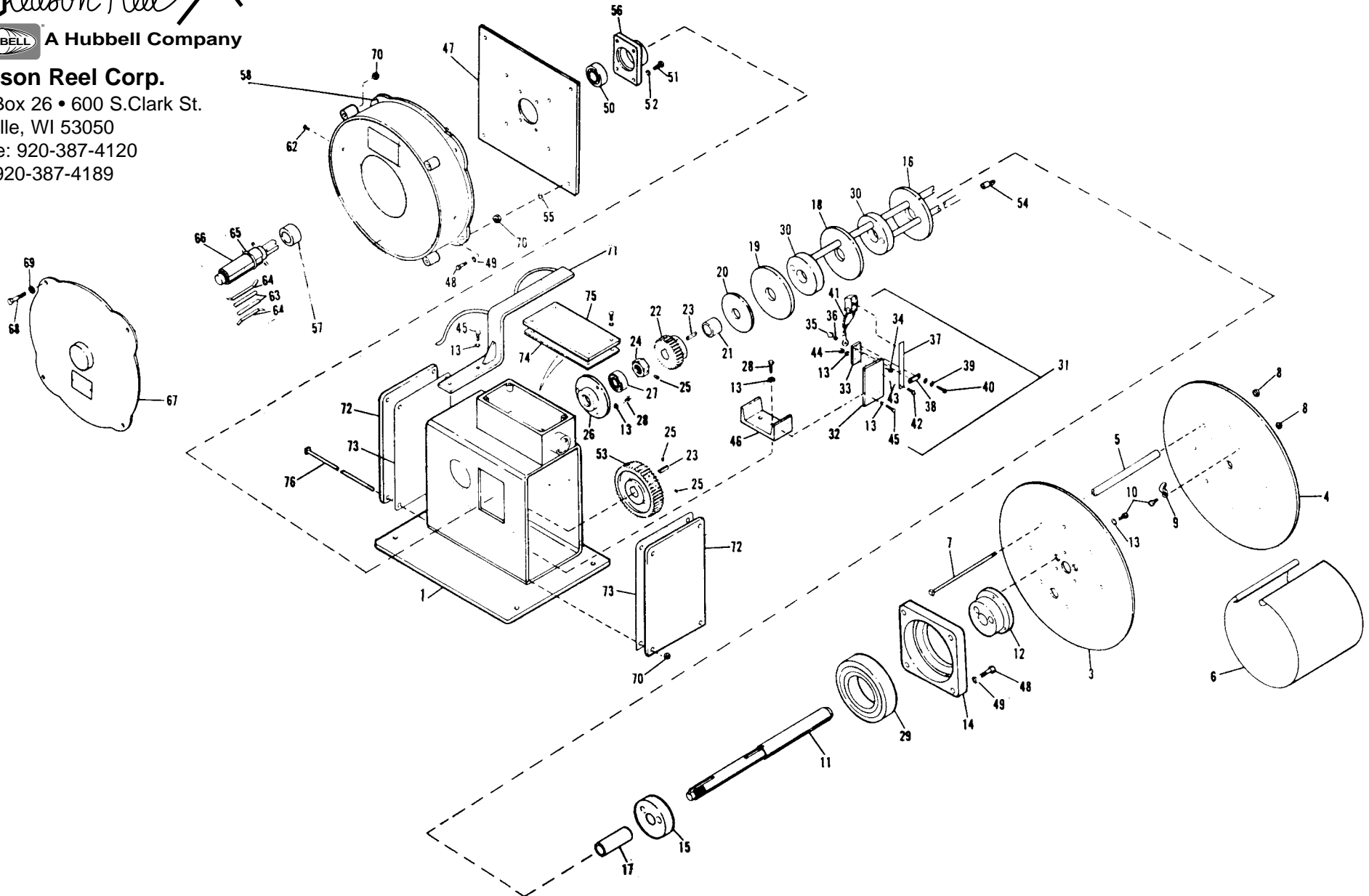

Always specify SERIAL NUMBER & MODEL NUMBER when ordering parts.  
 PRINTED IN USA

**SHO101A CABLE REEL REPLACEMENT PARTS**

# SHO101A CABLE REEL REPLACEMENT PARTS BULLETIN

ITEM	PART NO.	DESCRIPTION	REQ'D
1	005957	Frame Sub-Assembly	1
2	005960	Reel Sub-Assembly	1
3	G22-20	Drum Disc. - Inner	1
4	G21-33	Drum Disc. - Outer	1
5	G18-09	Pipe Spacer	8
6	G23-18	Drum Wrapper	1
7	106098	Machine Bolt	8
8	101263	Nut	9
9	106101	Clamp	1
10	103723	Machine Bolt	4
11	G01-34	Shaft	1
12	G78-01	Hub	1
13	101090	Lockwasher	17
14	G02-16	Retainer	1
15*	G18-10	Collar Spacer	1
16*	G16-06	Barrier #2	1
17*	G17-25	Sleeve	1
18*	G16-07	Barrier #1	1
19*	G16-08	Barrier B	1
20*	G37-03	Washer	1
21*	G47-02	Spacer	1
22*	101924	Gear - 30 Tooth	1
23	G67-01	Key	2
24	104405	Jam Nut	1
25	101269	Allen Hd. Setscrew	5
26	G02-17	Bearing Housing	1
27*	G36-05	Bearing	1
28	105096	Machine Bolt	3
29*	G36-14	Bearing	1
30*	005967	Collector Ring & Cable Assy.	2
31	005959	Brush Holder Sub Assembly	2
32*	G11-07	Terminal Plate	1 / ASSY
33*	G12-02	Contact Plate	1 / ASSY
34	101228	Flat Hd. Machine Screw	1 / ASSY
35	101218	Hex Nut	1 / ASSY
36	101086	Lockwasher	1 / ASSY
37*	G13-02	Finger	1 / ASSY
38*	G14-02	Strap	1 / ASSY

ITEM	PART NO.	DESCRIPTION	REQ'D
39	101085	Lockwasher	2 / ASSY
40	101215	Round Hd. Machine Screw	2 / ASSY
41*	G15-03	Brush	1 / ASSY
42	101303	Round Hd. Machine Screw	1 / ASSY
43	101262	Washer	2 / ASSY
44	101264	Hex Nut	1 / ASSY
45	101281	Machine Bolt	10
46	G10-15	Channel	1
47	G85-03	Mounting Plate	1
48	101062	Machine Bolt	13
49	101093	Lockwasher	12
50*	G36-03	Bearing	2
51	101075	Machine Bolt	4
52	101091	Lockwasher	4
53*	101932	Gear - 50 Tooth	1
54	101668	Lug	2
55	101211	Flatwasher	4
56	G02-08	Bearing Housing	1
57	G77-01	Spacer	1
58*	036138	Spring Housing Assy.	1
		Main Spring	1
		Hub	1
		Spring Housing	1
62	101038	Machine Screw	1
63*	G30-05	Pawl	3
64*	G31-05	Pawl Spring	2
65	G34-02	Snap Ring	1
66	G01-35	Spring Shaft	1
67	G05-08A	Cover Assembly	1
68	101357	Machine Bolt	4
69	101210	Flatwasher	4
70	101346	Nut	9
71	005962	Cable Guide	1
72	G05-12	Side Cover	2
73	G51-01	Side Gasket	2
74	G51-02	Top Gasket	1
75	G05-13	Top Cover	1
76	106099	Machine Bolt	1

\*Recommended Spare Parts for approximately one year service.