

GLEASON® PowerTrak

LX Type Model PT26LX-RN Parts List

ITEM	DESCRIPTION	PART NO.
1	Outer Link	046538
2	Inner Link—2.00 radius	04162804
	Inner Link—2.50 radius	04162806
	Inner Link—2.75 radius	04807501
	Inner Link—4.53 radius	04807502
	Inner Link—5.63 radius	04807503
3	Pin—PT26L Trak Splice*	044792
4	Aluminum Rod—4.00" lg.	04344602
	" 6.00" lg.	04344603
	" 8.00" lg.	04344604
	" 10.00" lg.	04344613
	" 12.00" lg.	04344614
5	Nylon Sleeve—3.88 lg.	03840707
	Nylon Sleeve—5.88	03840711
	Nylon Sleeve—7.88	03840715
	Nylon Sleeve—9.88	03840719
	Nylon Sleeve—11.88	03840723
6	Pan Head Locking Screw	047390
7	L.H. Mounting Bracket Kit <i>Includes Pins and E-Rings</i>	043384
8	R.H. Mounting Bracket Kit <i>Includes Pins and E-Rings</i>	043383

* Includes (6) pins and (6) E-rings. Used for splicing or repair. Original equipment has riveted construction.

SIDE CHAIN ASSEMBLY

Includes items 1 and 2, riveted together to form length in feet specified, rounded up to next full link.

Qty. 1 = one 1 ft. section for one side only.

L.H. and R.H. chains identical.

RADIUS	PART NO.
2.00	04916701
2.50	04916702
2.75	04916703
4.53	04916704
5.63	04916705

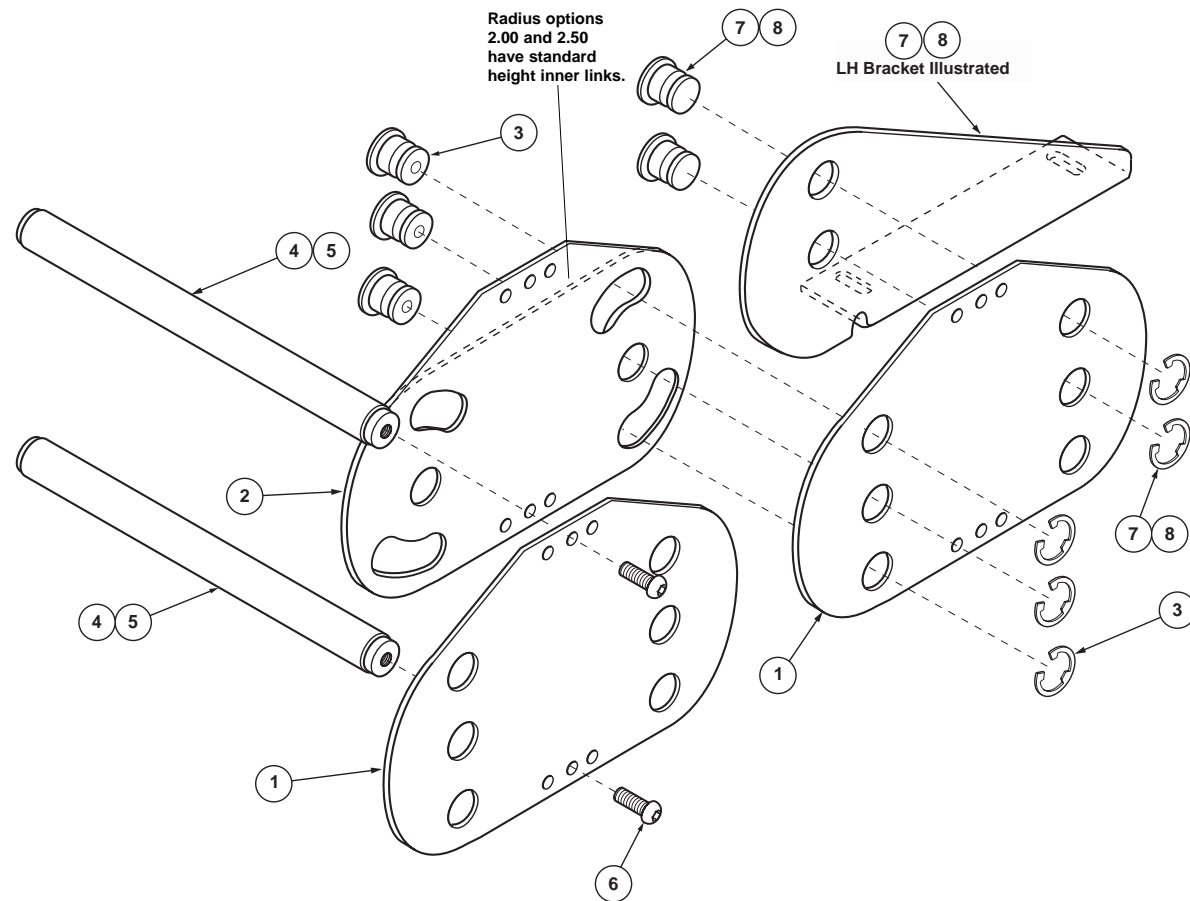

GLEASON REEL CORP.
P.O. Box 26 • 600 South Clark St.
Mayville, WI 53050-0026
Phone 920-387-4120 • Fax 920-387-4189