

P14 ELECTRIC CABLE REEL REPLACEMENT PARTS

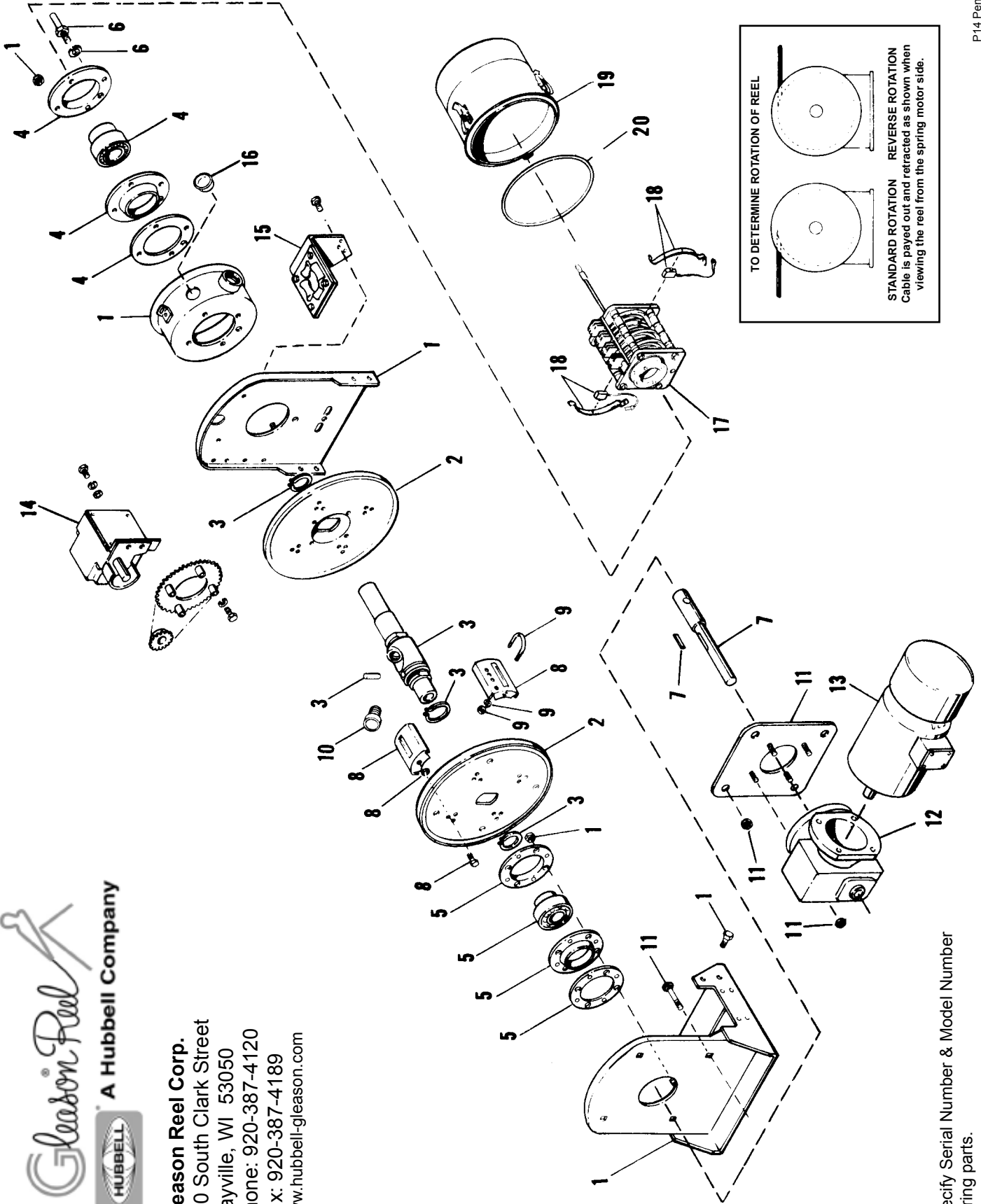

Gleason Reel Corp.
600 South Clark Street
Mayville, WI 53050
Phone: 920-387-4120
Fax: 920-387-4189
www.hubbell-gleason.com



TO DETERMINE ROTATION OF REEL

STANDARD ROTATION Cable is payed out and retracted as shown when viewing the reel from the spring motor side.

REVERSE ROTATION

Always specify Serial Number & Model Number when ordering parts.

P14 ELECTRIC CABLE REEL REPLACEMENT PARTS

ITEM	PART NO.	DESCRIPTION	QTY.	
1	012390	Frame Assembly	1	
		Frame Weldment	1	
		Vertical Frame	1	
		Collector Entrance Assembly	1	
		"Taptite" Screw, .31 - 18 x .62	4	
		Lockwasher .31	4	
		ESNA Nut .31 - 18	8	
2	012403	Discs	1	
		Disc - Drive End	1	
		Disc - Collector End	1	
3	012396	Main Shaft Assembly	1	
		Main Shaft	1	
		Stub Shaft Drive Pin	1	
		Retaining Ring	1	
		Retaining Ring	2	
4	012402	Bearing Kit - 2" Bore	1	
		Bearing - 2" Bore	1	
		Housing	1	
		Housing	1	
		Gasket	1	
5	012401	Bearing Kit - 1 3/4" Bore	1	
		Bearing 1 3/4" Bore	1	
		Housing	2	
		Gasket	1	
6	012456	Drive Stud Kit	1	
		Drive Stud Assembly	1	
		Lockwasher .44	1	
7	015744	Stub Shaft, .25 HP (P14 Only)	1	
		Stub Shaft	1	
		Key	1	
8	012415	Wrapper Kit - 4" Wide Dia.	1	
		Drum Wrapper 4.00	3	
		Drum Wrapper (Clamp)	1	
		Lockwasher .31	8	
		Hex. Hd. Capscrew .31 - 18 x .50	8	
9	012444	Cable Clamp Kit - .38 - .74 Dia. Cable	1	
		U-Bolt	1	
		Lockwasher .25	2	
		Nut Fin Hex. .25 - 20	2	
		012445	Cable Clamp Kit - .75 - 1.111 Dia. Cable	1
		012446	Cable Clamp Kit - 1.12 - 1.50 Dia. Cable	1
10	012459	Cable Connector .38 - .50 Cable Dia.	1	
		Cable Connector .50 - .62 Cable Dia.	1	
		Cable Connector .62 - .75 Cable Dia.	1	
		Cable Connector .75 - .88 Cable Dia.	1	
		Cable Connector .88 - 1.00 Cable Dia.	1	
		Cable Connector 1.00 - 1.12 Cable Dia.	1	
		Cable Connector 1.12 - 1.25 Cable Dia.	1	
		Cable Connector 1.25 - 1.38 Cable Dia.	1	
11	015747	Adapter Plate Kit, .25 HP	1	

ITEM	PART NO.	DESCRIPTION	QTY.	
		Adapter Plate	1	
		ESNA Nut .31 - 18	4	
		Carriage Bolt .50 - 13 x 2.00	4	
		ESNA Nut .50 - 13	4	
12	700349	Reducer, Gear .25 HP	1	
13	700353	Brake Motor, .25 HP	1	
14	012092	Rotary Limit Switch	1	
15	012079	Roller Guide Assy.	1	
16	012457	Button Plug	1	
17	012285	Collector Assembly, 2 Poles, 35 Amps.	1	
	012286	Collector Assembly, 3 Poles, 35 Amps.	1	
	012287	Collector Assembly, 4 Poles, 35 Amps.	1	
	012288	Collector Assembly, 6 Poles, 35 Amps.	1	
	012289	Collector Assembly, 8 Poles, 35 Amps.	1	
	012290	Collector Assembly, 10 Poles, 35 Amps.	1	
	012291	Collector Assembly, 12 Poles, 35 Amps.	1	
	012292	Collector Assembly, 14 Poles, 35 Amps.	1	
	012293	Collector Assembly, 16 Poles, 35 Amps.	1	
	012294	Collector Assembly, 20 Poles, 35 Amps.	1	
	012295	Collector Assembly, 24 Poles, 35 Amps.	1	
	012296	Collector Assembly, 30 Poles, 35 Amps.	1	
	012297	Collector Assembly, 36 Poles, 35 Amps.	1	
	012298	Collector Assembly, 2 Poles, 75 Amps.	1	
	012299	Collector Assembly, 3 Poles, 75 Amps.	1	
	012300	Collector Assembly, 4 Poles, 75 Amps.	1	
	012376	Collector Assembly, 6 Poles, 75 Amps.	1	
	012377	Collector Assembly, 8 Poles, 75 Amps.	1	
	037194	Collector Assembly, 2 Poles, 125 Amps.	1	
	037294	Collector Assembly, 3 Poles, 125 Amps.	1	
	037295	Collector Assembly, 4 Poles, 125 Amps.	1	
	012304	Collector Assembly, 2 Poles, 200 Amps.	1	
	012381	Collector Assembly, 3 Poles, 200 Amps.	1	
	012382	Collector Assembly, 4 Poles, 200 Amps.	1	
	012383	Collector Assembly, 6 Poles, 200 Amps.	1	
	012384	Collector Assembly, 8 Poles, 200 Amps.	1	
18	012440	Brush Kit (35 Amp.)	1	
		Brush	4	
		Finger	4	
		012441	Brush Kit (75 Amp.)	1
		012443	Brush Kit (125 Amp./200 Amp.)	1
19	012409	Collector Cover Kit (8" long)	1	
		Collector Cover Kit Assembly	1	
		Seal Ring	1	
		012410	Collector Cover Kit (10.5" long)	1
		012411	Collector Cover Kit (13" long)	1
		012412	Collector Cover Kit (15.5" long)	1
		012413	Collector Cover Kit (20.5" long)	1
		012414	Collector Cover Kit (28.5" long)	1
20	012458	Seal Ring	1	