



Optional nylon separators.  
Cables can be laid apart  
from each other.

“Snap fit” nylon bars facilitate  
cable installation. Aluminum  
rods also available

Special moving  
brackets for  
long travels.

Triple connecting pivot  
pin offers high structural  
integrity in high performance  
applications

Integral skids permit  
chain to slide on itself.  
Minimum wear thanks  
to special polymers.

Zinc plated steel  
mounting brackets.

## *Sliding Series* **Cable Carriers**

- Ideal for extra-long travel distances when used with guide trays.
- Internal height range: 1.18–2.76 inches (30–70mm)

# SLIDING SERIES

## SR326SI/SR326SE

Links feature antifriction pivots. Special skids permit chain to slide over itself in a guide tray allowing extended travel. Snap fit nylon bars removable from OUTER radius (SR326SE), or INNER radius (SR326SI). Standard carrier equipped with snap fit bars every second link. Also available with bars on every link. Movable separators can be installed to create different compartments.

Carrier part number	Radius R*** in (mm)	Curve Length M*** in (mm)	O.A. Height H*** in (mm)	Outside Width A in (mm)	Outside Height B in (mm)	Inside Width C lb/ft (kg/m)	Inside Height D in (mm)	Weight	Steel Brackets F
SR326SE(SI)061□□*				4.09 (104)	2.32 (59)	2.40 (61)	1.46 (37)	0.89 (1.33)	2.20 (56)
SR326SE(SI)072□□*				4.53 (115)	2.32 (59)	2.83 (72)	1.46 (37)	0.89 (1.33)	2.64 (67)
SR326SE(SI)086□□*				5.08 (129)	2.32 (59)	3.39 (86)	1.46 (37)	0.94 (1.40)	3.19 (81)
SR326SE(SI)092□□*	4.21 (107)	23.03 (585)	10.75 (273)	5.31 (135)	2.32 (59)	3.62 (92)	1.46 (37)	0.95 (1.41)	3.43 (87)
SR326SE(SI)106□□*				5.87 (149)	2.32 (59)	4.17 (106)	1.46 (37)	0.98 (1.46)	3.98 (101)
SR326SE(SI)111□□*				6.06 (154)	2.32 (59)	4.37 (111)	1.46 (37)	0.98 (1.46)	4.17 (106)
SR326SE(SI)118□□*	5.91 (150)	40.94(1040)	14.13 (359)	6.34 (161)	2.32 (59)	4.65 (118)	1.46 (37)	0.99 (1.48)	4.45 (113)
SR326SE(SI)128□□*				6.73 (171)	2.32 (59)	5.04 (128)	1.46 (37)	1.00 (1.49)	4.84 (123)
SR326SE(SI)136□□*				7.05 (179)	2.32 (59)	5.35 (136)	1.46 (37)	1.03 (1.54)	5.16 (131)
SR326SE(SI)147□□*	7.87 (200)	56.30(1430)	18.07 (459)	7.48 (190)	2.32 (59)	5.79 (147)	1.46 (37)	1.06 (1.57)	5.59 (142)
SR326SE(SI)161□□*				8.03 (204)	2.32 (59)	6.34 (161)	1.46 (37)	1.08 (1.61)	6.14 (156)
SR326SE(SI)186□□*				9.01 (229)	2.32 (59)	7.33 (186)	1.46 (37)	1.13 (1.68)	7.13 (181)
SR326SE(SI)211□□*	9.84 (250)	74.80(1900)	22.01 (559)	10.00 (254)	2.32 (59)	8.31 (211)	1.46 (37)	1.18 (1.75)	8.11 (206)
SR326SE(SI)222□□*				10.43 (265)	2.32 (59)	8.74 (222)	1.46 (37)	1.20 (1.79)	8.54 (217)
SR326SE(SI)236□□*				10.98 (279)	2.32 (59)	9.29 (236)	1.46 (37)	1.23 (1.83)	9.09 (231)
SR326SE(SI)263□□*	11.81(300)	92.13(2340)	25.94 (659)	12.05 (306)	2.32 (59)	10.35(263)	1.46 (37)	1.28 (1.91)	10.16(258)
SR326SE(SI)272□□*				12.40 (315)	2.32 (59)	10.71(272)	1.46 (37)	1.30 (1.93)	10.51(267)
SR326SE(SI)323□□*				14.41 (366)	2.32 (59)	12.72(323)	1.46 (37)	1.38 (2.06)	12.52(318)
SR326SE(SI)345□□*				15.28 (388)	2.32 (59)	13.58(345)	1.46 (37)	1.48 (2.20)	13.38(340)
SR326SE(SI)373□□*				16.38 (416)	2.32 (59)	14.69(373)	1.46 (37)	1.49 (2.21)	14.49(368)

\* Complete model number by inserting value of radius (R) in mm: Example—SR326SI236 **2** **0** **0**  
 NOTE: Specify whether snap fit bars are to open to inner radius (SI) or outer radius (SE). Standard carrier has bars on every second link. If bars are to be on every link, add **D** to end of model number: Example—SR326SI236200D.  
 \*\* Refer to diagram on back page.

Technical characteristics when self-supported	
Speed	6.56 ft/s (2 m/s)
Acceleration	13.12 ft/s <sup>2</sup> (4 m/s <sup>2</sup> )
Pitch	2.56 in. (65 mm)

Separator	
Unassembled p/n	S660A
Assembled p/n	S660AMC

Pin	
part no.	PG307

Mounting Brackets	
Complete set, Assembled	Zinc Plated Steel® p/n A326KM
Complete set, Unassembled	Zinc Plated Steel® p/n A326K

Pin	
Removal Tool	p/n PZ036

①Also available in stainless steel.

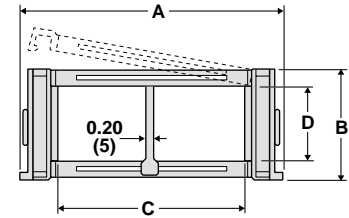

### Mounting Bracket details.

Sold in sets, two brackets for fixed end and two for moving end. Details same for all models on this page. Dimensions in inches (mm).

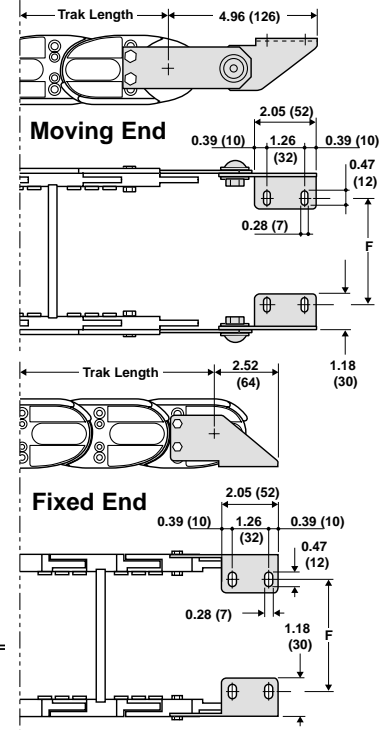

# SLIDING SERIES

## SR326B

Features aluminum rods which may be cut to length for custom inner width (C). Links have antifriction pivots. Special skids permit chain to slide over itself in a guide tray allowing extended travel. Standard carrier equipped with aluminum rods every second link. Also available with rods on every link. Movable separators can be installed to create different compartments.

Carrier part number	Radius R*** in (mm)	Curve Length M*** in (mm)	O.A. Height H*** in (mm)	Outside Width A in (mm)	Outside Height B in (mm)	Inside Width C in (mm)	Inside Height D in (mm)	Weight lb/ft (kg/m)	Steel Brackets F in (mm)
SR316B075*				4.53 (115)	2.32 (59)	2.95 (75)	1.18 (30)	1.18 (1.75)	2.64 (67)
SR316B100*	4.21 (107)	23.03 (585)	10.75 (273)	5.51 (140)	2.32 (59)	3.94 (100)	1.18 (30)	1.21 (1.80)	3.62 (92)
SR316B150*	5.91 (150)	40.94(1040)	14.13 (359)	7.48 (190)	2.32 (59)	5.91 (150)	1.18 (30)	1.28 (1.90)	5.59 (142)
SR316B200*	7.87 (200)	56.30(1430)	18.07 (459)	9.45 (240)	2.32 (59)	7.87 (200)	1.18 (30)	1.37 (2.05)	7.56 (192)
SR316B250*	9.84 (250)	74.80(1900)	22.01 (559)	11.42 (290)	2.32 (59)	9.84 (250)	1.18 (30)	1.44 (2.15)	9.53 (242)
SR316B300*	11.81(300)	92.13(2340)	25.94 (659)	13.39 (340)	2.32 (59)	11.81(300)	1.18 (30)	1.51 (2.25)	11.50(292)
SR316B□□□**				C+1.57(C+40)	2.32 (59)	-	1.18 (30)	-	A-1.89(A-48)

\* Complete model number by inserting value of radius (R) in mm: Example—SR326B150 **3**  
 Where: 2=107; 3=150; 4=200; 6=300  
 \*\* Complete model number by inserting the value of the C dimension (mm) and the radius (R): Example: SR326B **2** **1** **5** **3**  
 Standard carrier has bars on every second link. If bars are to be on every link, add **D** to end of model number: Example—SR326B1503D.  
 \*\*\* Refer to diagram on back page.

Technical characteristics when self-supported	
Speed	6.56 ft/s (2 m/s)
Acceleration	13.12 ft/s <sup>2</sup> (4 m/s <sup>2</sup> )
Pitch	2.56 in. (65 mm)

Separator	
Unassembled p/n	S2000F
Assembled p/n	S2000FMC

Pin	
part no.	PG307

Mounting Brackets	
Complete set, Assembled	Zinc Plated Steel® p/n A326KM
Complete set, Unassembled	Zinc Plated Steel® p/n A326K

Pin	
Removal Tool	p/n PZ036

①Also available in stainless steel.

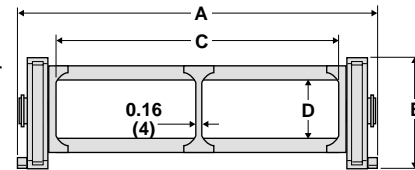

# SLIDING SERIES

## SR328SI/SR328SE

Similar to but larger than SR316 series.. Special skids permit chain to slide over itself in a guide tray allowing extended travel. Snap fit nylon bars removable from OUTER radius (SR328SE), or INNER radius (SR328SI). Standard carrier equipped with snap fit bars every second link. Also available with bars on every link. Movable separators can be installed to create compartments.

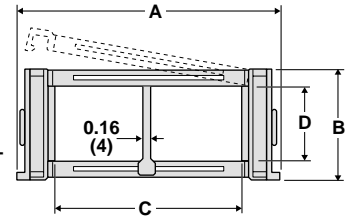

Carrier part number	Radius R*** in (mm)	Curve Length M*** in (mm)	O.A. Height H*** in (mm)	Outside Width A in (mm)	Outside Height B in (mm)	Inside Width C in (mm)	Inside Height D in (mm)	Weight lb/ft (kg/m)	Steel Brackets F in (mm)
SR328SE(SI)061□□□*				4.57 (116)	3.11 (79)	2.40 (61)	2.24 (57)	1.28 (1.91)	1.85 (47)
SR328SE(SI)072□□□*				5.00 (127)	3.11 (79)	2.83 (72)	2.24 (57)	1.28 (1.91)	2.28 (58)
SR328SE(SI)086□□□*				5.55 (141)	3.11 (79)	3.39 (86)	2.24 (57)	1.32 (1.96)	2.83 (72)
SR328SE(SI)092□□□*				5.79 (147)	3.11 (79)	3.62 (92)	2.24 (57)	1.33 (1.98)	3.07 (78)
SR328SE(SI)106□□□*	5.91 (150)	40.94 (1040)	14.76 (375)	6.34 (161)	3.11 (79)	4.17 (106)	2.24 (57)	1.35 (2.01)	3.62 (92)
SR328SE(SI)111□□□*				6.54 (166)	3.11 (79)	4.37 (111)	2.24 (57)	1.35 (2.01)	3.82 (97)
SR328SE(SI)118□□□*	7.09 (180)	48.43 (1230)	17.13 (435)	6.81 (173)	3.11 (79)	4.65 (118)	2.24 (57)	1.36 (2.03)	4.09 (104)
SR328SE(SI)128□□□*				7.20 (183)	3.11 (79)	5.04 (128)	2.24 (57)	1.37 (2.04)	4.49 (114)
SR328SE(SI)136□□□*	7.87 (200)	53.54 (1360)	18.70 (475)	7.52 (191)	3.11 (79)	5.35 (136)	2.24 (57)	1.40 (2.08)	4.80 (122)
SR328SE(SI)147□□□*				7.95 (202)	3.11 (79)	5.79 (147)	2.24 (57)	1.42 (2.11)	5.24 (133)
SR328SE(SI)161□□□*	9.06 (230)	62.99 (1600)	21.06 (535)	8.50 (216)	3.11 (79)	6.34 (161)	2.24 (57)	1.43 (2.13)	5.79 (147)
SR328SE(SI)186□□□*				9.49 (241)	3.11 (79)	7.33 (186)	2.24 (57)	1.47 (2.19)	6.77 (172)
SR328SE(SI)211□□□*	11.02 (280)	78.74 (2000)	25.00 (635)	10.47 (266)	3.11 (79)	8.31 (211)	2.24 (57)	1.51 (2.25)	7.76 (197)
SR328SE(SI)222□□□*				10.91 (277)	3.11 (79)	8.74 (222)	2.24 (57)	1.53 (2.28)	8.19 (208)
SR328SE(SI)236□□□*	15.75 (400)	119.69(3040)	34.45 (875)	11.46 (291)	3.11 (79)	9.29 (236)	2.24 (57)	1.55 (2.31)	8.74 (222)
SR328SE(SI)263□□□*				12.52 (318)	3.11 (79)	10.35(263)	2.24 (57)	1.60 (2.38)	9.80 (249)
SR328SE(SI)272□□□*				12.87 (327)	3.11 (79)	10.71(272)	2.24 (57)	1.61 (2.40)	10.16(258)
SR328SE(SI)323□□□*				14.88 (378)	3.11 (79)	12.72(323)	2.24 (57)	1.68 (2.50)	12.17(309)
SR328SE(SI)345□□□*				15.74 (400)	3.11 (79)	13.58(345)	2.24 (57)	1.71 (2.55)	13.03(331)
SR328SE(SI)373□□□*				16.85 (428)	3.11 (79)	14.69(373)	2.24 (57)	1.76 (2.62)	14.13(359)

\* Complete model number by inserting value of radius (R) in mm: Example-SR328SI236 **2** **0** **0**

NOTE: Specify whether snap fit bars are to open to inner radius (SI) or outer radius (SE). Standard carrier has bars on every second link. If bars are to be on every link, add D to end of model number: Example-SR328SI236200D.

\*\* Refer to diagram on back page.

Technical characteristics when self-supported	
Speed	11.48 ft/s (3.5 m/s)
Acceleration	26.25 ft/s <sup>2</sup> (8 m/s <sup>2</sup> )
Pitch	3.15 in. (80 mm)

Separator	
Unassembled p/n	S308C
Assembled p/n	S308CMC

Pin part no. PG328TP

Pin Removal Tool p/n PZ038

### Mounting Brackets

Complete set, Assembled	Zinc Plated Steelⓐ p/n A328KM
Complete set, Unassembled	Zinc Plated Steelⓐ p/n A328K

ⓐAlso available in stainless steel.

### Mounting Bracket details.

Sold in sets, two brackets for fixed end and two for moving end. Details same for all models on this page. Dimensions in inches (mm).

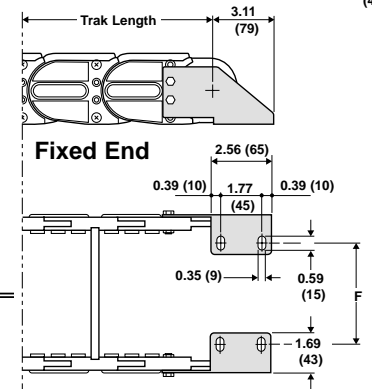
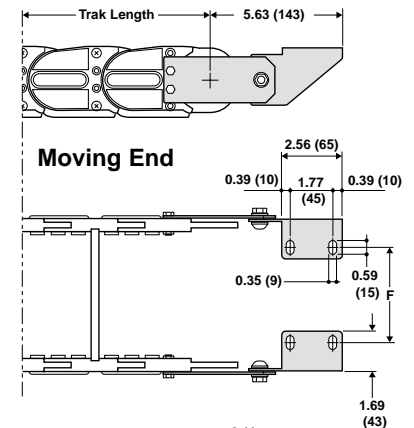

# SLIDING SERIES

## SR328B

Features aluminum rods which may be cut to length for custom inner width (C). Links have antifriction pivots. Special skids permit chain to slide over itself in a guide tray allowing extended travel. Standard carrier equipped with aluminum rods every second link. Also available with rods on every link. Movable separators can be installed to create different compartments.

Carrier part number	Radius R*** in (mm)	Curve Length M*** in (mm)	O.A. Height H*** in (mm)	Outside Width A in (mm)	Outside Height B in (mm)	Inside Width C in (mm)	Inside Height D in (mm)	Weight lb/ft (kg/m)	Steel Brackets F in (mm)
SR328B100□□□*	5.91 (150)	37.60 (955)	14.76 (375)	6.38 (162)	3.11 (79)	3.94 (100)	1.89 (48)	1.68 (2.50)	3.66 (93)
SR328B150□□□*	7.09 (180)	48.03 (1220)	17.13 (435)	8.35 (212)	3.11 (79)	5.91 (150)	1.89 (48)	1.75 (2.60)	5.63 (143)
SR328B200□□□*	7.87 (200)	54.92 (1395)	18.70 (475)	10.31 (262)	3.11 (79)	7.87 (200)	1.89 (48)	1.85 (2.75)	7.60 (193)
SR328B250□□□*	9.06 (230)	65.16 (1655)	21.06 (535)	12.28 (312)	3.11 (79)	9.84 (250)	1.89 (48)	1.95 (2.90)	9.57 (243)
SR328B300□□□*	11.02(280)	82.48 (2095)	25.00 (635)	14.25 (362)	3.11 (79)	11.81 (300)	1.89 (48)	2.02 (3.00)	11.54(293)
SR328B□□□□□**	15.75(400)	123.82(3145)	34.45 (875)	C+2.44(C+62)	3.11 (79)	-	1.89 (48)	-	A-2.72(A-69)

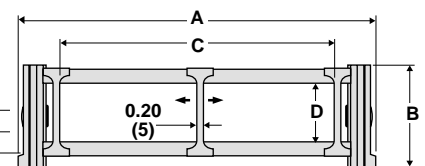

\* Complete model number by inserting value of radius (R) in mm: Example-SR328B250 **2** **3** **0**

\*\* Complete model number by inserting the value of the C dimension (mm) and the radius (R): Example: SR328B **1** **9** **0** **2** **3** **0**

Standard carrier has bars on every second link. If bars are to be on every link, add D to end of model number: Example-SR328B250230D.

\*\*\* Refer to diagram on back page.

Technical characteristics when self-supported	
Speed	11.48 ft/s (3.5 m/s)
Acceleration	26.25 ft/s <sup>2</sup> (8 m/s <sup>2</sup> )
Pitch	3.15 in. (80 mm)

Separator	
Unassembled p/n	S3000F
Assembled p/n	S3000FMC

Pin part no. PG328TP

Pin Removal Tool p/n PZ038

### Mounting Brackets

Complete set, Assembled	Zinc Plated Steelⓐ p/n A328KM
Complete set, Unassembled	Zinc Plated Steelⓐ p/n A328K

ⓐAlso available in stainless steel.

# SLIDING SERIES

## SR319PSB

Largest carrier in sliding series with 2.76" (70 mm) inner height. SR319PSB features aluminum rods which may be cut to length for custom inner width (C). Links have antifriction pivots. Special skids permit chain to slide over itself in a guide tray allowing extended travel. Standard carrier equipped with aluminum rods every second link. Also available with rods on every link. Movable separators can be installed to create different compartments.

Carrier part number	Radius R*** in (mm)	Curve Length M*** in (mm)	O.A. Height H*** in (mm)	Outside Width A in (mm)	Outside Height B in (mm)	Inside Width C in (mm)	Inside Height D in (mm)	Weight lb/ft (kg/m)	Steel Brackets F in (mm)
SR319PSB100□*				6.46 (164)	4.21 (107)	3.94 (100)	2.76 (70)	2.86 (4.25)	2.99 (76)
SR319PSB150□*	7.87 (200)	52.95 (1345)	19.96 (507)	8.43 (214)	4.21 (107)	5.91 (150)	2.76 (70)	2.99 (4.45)	4.96 (126)
SR319PSB200□*	9.84 (250)	70.08 (1780)	23.90 (607)	10.39 (264)	4.21 (107)	7.87 (200)	2.76 (70)	3.09 (4.60)	6.93 (176)
SR319PSB250□*	11.81 (300)	87.40 (2220)	27.83 (707)	12.36 (314)	4.21 (107)	9.84 (250)	2.76 (70)	3.19 (4.75)	8.90 (226)
SR319PSB300□*	13.78 (350)	104.53(2655)	31.77 (807)	14.33 (364)	4.21 (107)	11.81(300)	2.76 (70)	3.29 (4.90)	10.87(276)
SR319PSB400□*	15.75 (400)	121.85(3095)	35.71 (907)	18.27 (464)	4.21 (107)	15.75(400)	2.76 (70)	3.53 (5.25)	14.80(376)
SR319PSB□□□□**	19.69 (500)	156.30(3970)	43.58(1107)	C+2.52 (64)	4.21 (107)	-	2.76 (70)		A-3.46 (88)

\* Complete model number by inserting value of radius (R) in mm: Example-SR319PSB200□3

Where: 2=200; 3=250; 4=300; 5=350; 6=400; 7=500

\*\* Complete model number by inserting the value of the C dimension (mm) and the radius (R):

Example: SR319PSB 2 1 5 3

Standard carrier has aluminum rods on every second link. If rods are to be on every link, add D to end of model number: Example-SR319PSB2003D.

\*\*\* Refer to diagram below.

### Technical characteristics when self-supported

Speed	13.12 ft/s (4 m/s)
Acceleration	42.64 ft/s <sup>2</sup> (13 m/s <sup>2</sup> )
Pitch	3.94 in. (100 mm)

Separator	
Unassembled p/n	S309C
Assembled p/n	S309MC

Pin part no.	PG319
--------------	-------

### Mounting Brackets

Complete set, Assembled	Zinc Plated Steel® p/n A319KM
Complete set, Unassembled	Zinc Plated Steel® p/n A319K

One set includes two brackets for moving end and two brackets for fixed end.

①Also available in stainless steel.

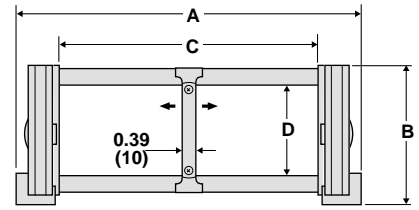

### Mounting Bracket details.

Sold in sets, two brackets for fixed end and two for moving end. Details same for all models on this page. Dimensions in inches (mm).

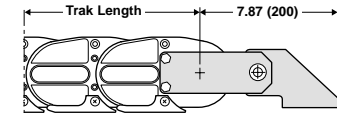

### Moving End

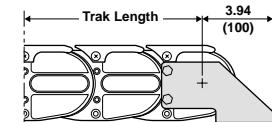
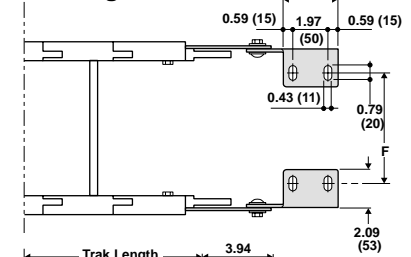

### Fixed End

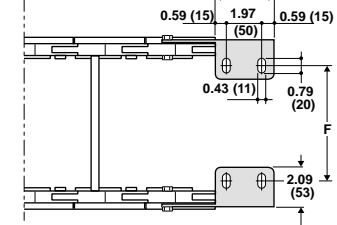

### Chain Length Diagram (applies to all models)

Chain length required equals 1/2 total travel plus length of curve (M)

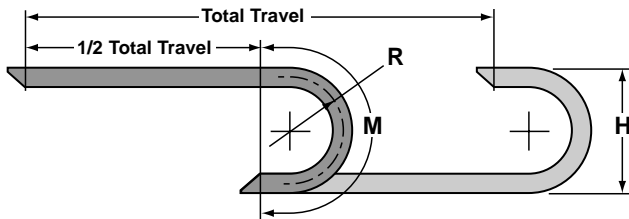

Ask your Gleason Representative about the full cable carrier line.

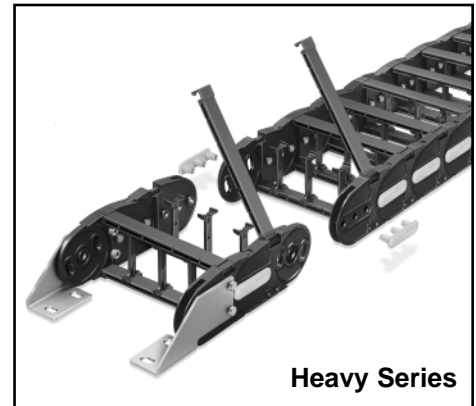
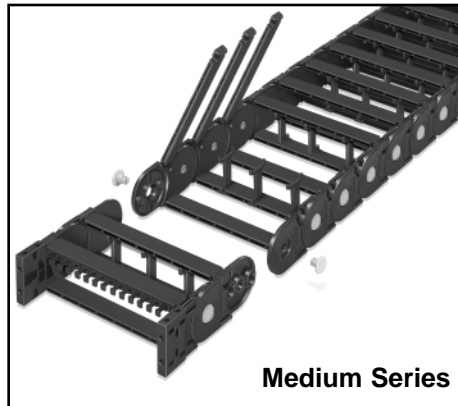
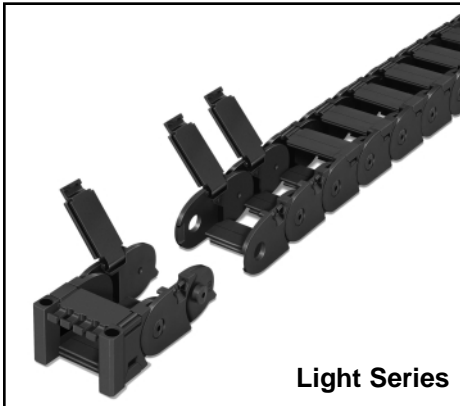

### Gleason Reel Corp.

600 South Clark Street  
 P.O. Box 26  
 Mayville, WI 53050  
 Phone: 920-387-4120 Fax: 920-387-4189  
 www.hubbell-gleason.com