

Medium Series **Cable Carriers**

SR300, SR305, SR355, SR400, SR300A, SR305A, SR355A

- Enclosed on Outer Radius for greatest cable/hose protection
- Internal height range: 0.67-1.22 inches (17-31mm)

MEDIUM SERIES

SR300/SR305/SR355

One piece molded nylon links with antifriction pivots. Completely enclosed on outer radius. Movable separators on SR305 and SR355 can be installed to create different compartments. Carrier length can be easily field customized.

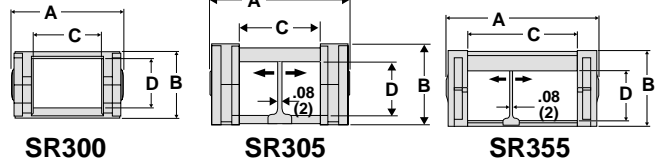

Carrier part number	Radius R** in (mm)	Curve Length M** in (mm)	O.A. Height H** in (mm)	Outside Width A in (mm)	Outside Height B in (mm)	Inside Width C in (mm)	Inside Height D in (mm)	Weight lb/ft (kg/m)	Steel Bracket Dimensions
SR300015□□□*	1.57 (040)	7.28 (185)	4.06 (103)	1.18 (30)	0.91 (23)	0.55 (14)	0.71 (18)	0.26 (0.38)	See drawings at right
SR300025□□□*	2.36 (060)	9.76 (248)	5.63 (143)	1.61 (41)	0.91 (23)	0.98 (25)	0.71 (18)	0.29 (0.43)	See drawings at right
SR300035□□□*	3.15 (080)	12.40(315)	7.20 (183)	2.08 (52)	0.91 (23)	1.42 (36)	0.71 (18)	0.33 (0.48)	See drawings at right

* Complete model number by inserting value of radius (R) in mm: Example—SR300025 1 | 2 | 0

** Refer to diagram on back page.

Technical characteristics: self-supported			Technical characteristics: long travel			Pin	Pin Removal Tool
Speed	32.81 ft/s (10 m/s)		Speed	0.98 ft/s (0.3 m/s)		Part no. PG300	Part no. PZ010
Acceleration	164.04 ft/s ² (50 m/s ²)		Acceleration	3.28 ft/s ² (1 m/s ²)			
Pitch	1.18 in. (30 mm)						

Zinc Plated Mounting Brackets ^①	For Models SR30015	For Models SR30025	For Models SR30035
Complete set, assembled	p/n AP300KM□ ^②	p/n AG300KM□ ^②	p/n A300035KM□ ^②
Complete set, unassembled	p/n AP300K□ ^②	p/n AG300K□ ^②	p/n AG300035K□ ^②

① Also available in stainless steel.

② Indicate mounting position variation. See drawings on back page.

Mounting Brackets.

Sold in sets of two.

Zinc Plated Steel^①

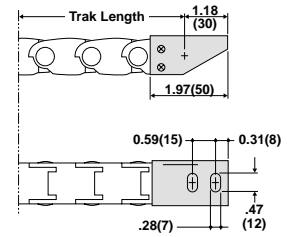

Carrier part number	Radius R* in (mm)	Curve Length M* in (mm)	O.A. Height H* in (mm)	Outside Width A in (mm)	Outside Height B in (mm)	Inside Width C in (mm)	Inside Height D in (mm)	Weight lb/ft (kg/m)	Nylon Bracket F in (mm)	Steel Bracket F in (mm)
SR305008	1.97 (050)	9.06 (230)	5.12 (130)	2.05 (52)	1.18 (30)	1.18 (30)	0.79 (20)	0.60 (0.90)	1.61 (41)	1.22 (31)
SR305010	2.76 (070)	11.42(290)	6.69 (170)	2.05 (52)	1.18 (30)	1.18 (30)	0.79 (20)	0.60 (0.90)	1.61 (41)	1.22 (31)
SR305020	4.72 (120)	17.72(450)	10.63(270)	2.05 (52)	1.18 (30)	1.18 (30)	0.79 (20)	0.60 (0.90)	1.61 (41)	1.22 (31)
SR305050	5.91 (150)	21.46(545)	12.99(330)	2.05 (52)	1.18 (30)	1.18 (30)	0.79 (20)	0.60 (0.90)	1.61 (41)	1.22 (31)
SR305009	1.97 (050)	9.06 (230)	5.12 (130)	2.83 (72)	1.18 (30)	1.97 (50)	0.79 (20)	0.67 (1.00)	2.40 (61)	2.05 (52)
SR305030	2.76 (070)	11.42(290)	6.69 (170)	2.83 (72)	1.18 (30)	1.97 (50)	0.79 (20)	0.67 (1.00)	2.40 (61)	2.05 (52)
SR305040	4.72 (120)	17.72(450)	10.63(270)	2.83 (72)	1.18 (30)	1.97 (50)	0.79 (20)	0.67 (1.00)	2.40 (61)	2.05 (52)
SR305060	5.91 (150)	21.46(545)	12.99(330)	2.83 (72)	1.18 (30)	1.97 (50)	0.79 (20)	0.67 (1.00)	2.40 (61)	2.05 (52)

* Refer to diagram on back page.

Technical characteristics: Self-supported			Technical characteristics: Long Travel			Separator	Pin
Speed	32.81 ft/s (10 m/s)		Speed	1.64 ft/s (0.5 m/s)		Unassembled—S305	Part no. PG305
Acceleration	164.04 ft/s ² (50 m/s ²)		Acceleration	3.28 ft/s ² (1 m/s ²)		Assembled—S305MC	Pin Removal Tool Part no. PZ010
Pitch	1.38 in. (35 mm)						

Mounting Brackets

Complete set, assembled	Nylon p/n AN305KM	Zinc Plated Steel ^① , 2.05" wide, p/n AP305KM□ ^②
Complete set, unassembled	Nylon p/n AN305K	Zinc Plated Steel ^① , 2.83" wide, p/n AG305KM□ ^②
		Zinc Plated Steel ^① , 2.05" wide, p/n AP305K□ ^②
		Zinc Plated Steel ^① , 2.83" wide, p/n AG305K□ ^②

① Also available in stainless steel

② Indicate mounting position variation. See drawings on back page

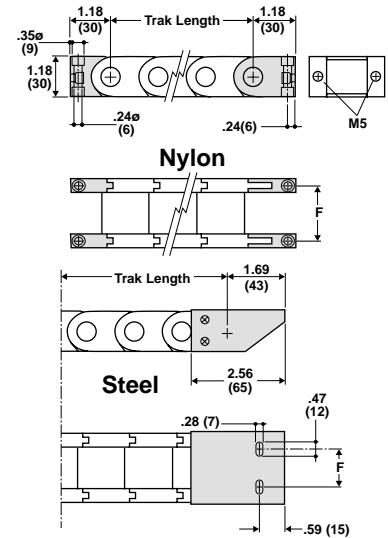

Carrier part number	Radius R* in (mm)	Curve Length M* in (mm)	O.A. Height H* in (mm)	Outside Width A in (mm)	Outside Height B in (mm)	Inside Width C in (mm)	Inside Height D in (mm)	Weight lb/ft (kg/m)	Nylon Bracket F in (mm)	Steel Bracket F in (mm)
SR355045	2.95 (075)	12.40 (315)	7.68 (195)	2.91 (74)	1.77 (45)	1.77 (45)	1.18 (30)	0.91 (1.35)	2.24 (57)	1.97 (50)
SR355046	3.94 (100)	15.55 (395)	9.65 (245)	2.91 (74)	1.77 (45)	1.77 (45)	1.18 (30)	0.91 (1.35)	2.24 (57)	1.97 (50)
SR355047	5.91 (150)	21.85 (555)	13.85(345)	2.91 (74)	1.77 (45)	1.77 (45)	1.18 (30)	0.91 (1.35)	2.24 (57)	1.97 (50)
SR355048	7.87 (200)	27.95 (710)	17.52(445)	2.91 (74)	1.77 (45)	1.77 (45)	1.18 (30)	0.91 (1.35)	2.24 (57)	1.97 (50)
SR355065	2.95 (075)	12.40 (315)	7.68 (195)	3.70 (94)	1.77 (45)	2.56 (65)	1.18 (30)	0.97 (1.45)	3.03 (77)	2.76 (70)
SR355066	3.94 (100)	15.55 (395)	9.65 (245)	3.70 (94)	1.77 (45)	2.56 (65)	1.18 (30)	0.97 (1.45)	3.03 (77)	2.76 (70)
SR355067	5.91 (150)	21.85 (555)	13.85(345)	3.70 (94)	1.77 (45)	2.56 (65)	1.18 (30)	0.97 (1.45)	3.03 (77)	2.76 (70)
SR355068	7.87 (200)	27.85 (710)	17.52(445)	3.70 (94)	1.77 (45)	2.56 (65)	1.18 (30)	0.97 (1.45)	3.03 (77)	2.76 (70)
SR355095	2.95 (075)	12.40 (315)	7.68 (195)	4.88(124)	1.77 (45)	3.74 (95)	1.18 (30)	1.11 (1.65)	4.21 (107)	3.94 (100)
SR355096	3.94 (100)	15.55 (395)	9.65 (245)	4.88(124)	1.77 (45)	3.74 (95)	1.18 (30)	1.11 (1.65)	4.21 (107)	3.94 (100)
SR355097	5.91 (150)	21.85 (555)	13.85(345)	4.88(124)	1.77 (45)	3.74 (95)	1.18 (30)	1.11 (1.65)	4.21 (107)	3.94 (100)
SR355098	7.87 (200)	27.85 (710)	17.52(445)	4.88(124)	1.77 (45)	3.74 (95)	1.18 (30)	1.11 (1.65)	4.21 (107)	3.94 (100)

* Refer to diagram on back page.

Technical characteristics: Self-supported			Technical characteristics: Long Travel			Separator	Pin
Speed	32.81 ft/s (10 m/s)		Speed	1.64 ft/s (0.5 m/s)		Unassembled—S355	Part no. PG355
Acceleration	164.04 ft/s ² (50 m/s ²)		Acceleration	3.28 ft/s ² (1 m/s ²)		Assembled—S355MC	Pin Removal Tool Part no. PZ010
Pitch	1.57 in. (40 mm)						

Mounting Brackets

Complete set, assembled	Nylon p/n AN355KM	Zinc Plated Steel ^① , 2.91" wide, p/n AP355KM□ ^②
Complete set, unassembled	Nylon p/n AN355K	Zinc Plated Steel ^① , 3.70" wide, p/n AM355KM□ ^②
		Zinc Plated Steel ^① , 4.88" wide, p/n AG355KM□ ^②
		Zinc Plated Steel ^① , 2.91" wide, p/n AP355K□ ^②
		Zinc Plated Steel ^① , 3.70" wide, p/n AM355K□ ^②
		Zinc Plated Steel ^① , 4.88" wide, p/n AG355K□ ^②

① Also available in stainless steel

② Indicate mounting position variation. See drawings on back page

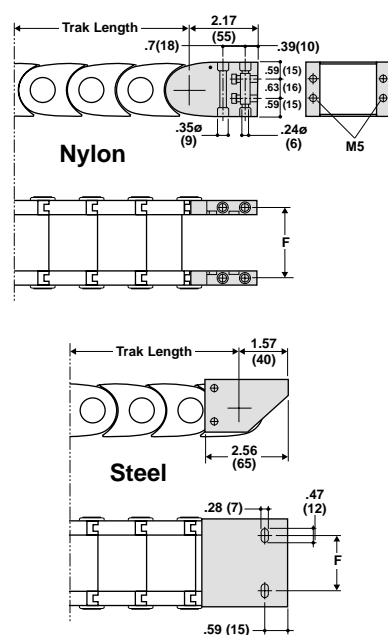

MEDIUM SERIES

SR300A/SR305A/SR355A

Molded nylon links with antifriction pivots. Completely enclosed on outer radius. Snap fit bars removable from inner radius to facilitate cable installation. Movable separators can be installed to create different compartments. Carrier length can be easily field customized.

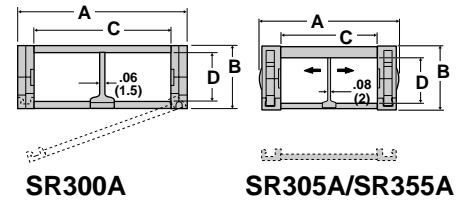

Carrier part number	Radius R** in (mm)	Curve Length M** in (mm)	O.A. Height H** in (mm)	Outside Width A in (mm)	Outside Height B in (mm)	Inside Width C in (mm)	Inside Height D in (mm)	Weight lb/ft (kg/m)	Nylon Bracket F in (mm)	Steel Bracket F in (mm)
SR300A015□□□*	1.57 (040)	7.28 (185)	4.06 (103)	1.06 (27)	0.91 (23)	0.59 (15)	0.71 (18)	0.28 (0.41)	See drawings at right	
SR300A025□□□*	2.36 (060)	9.84 (250)	5.63 (143)	1.46 (37)	0.91 (23)	0.98 (25)	0.71 (18)	0.30 (0.45)	See drawings at right	
SR300A050□□□*	3.15 (080)	12.40(315)	7.20 (183)	2.44 (62)	0.91 (23)	1.97 (50)	0.71 (18)	0.37 (0.55)	0.98 (25)	0.98 (25)
SR300A075□□□*	4.72 (120)	17.32(440)	10.35(263)	3.43 (87)	0.91 (23)	2.95 (75)	0.71 (18)	0.44 (0.65)	1.97 (50)	1.97 (50)

* Complete model number by inserting value of radius (R) in mm: Example—SR300A025 **0 8 0**
 ** Refer to diagram on back page.

Technical characteristics when self-supported	Separator	Pin	Pin Removal Tool
Speed 32.81 ft/s (10 m/s)	SR300A050 & SR300A075 only	Part no. PG300A	Part no. PZ010
Acceleration 164.04 ft/s ² (50 m/s ²)	Unassembled p/n S300A		
Pitch 1.18 in. (30 mm)	Assembled p/n S300AMC		

End Brackets	Nylon p/n	Steel p/n
Complete set, assembled	AN300A□□□□2KM	Zinc Plated Steel① p/n A300A□□□□2KM
Complete set, unassembled	AN300A□□□□2K	Zinc Plated Steel① p/n A300A□□□□2K

- ① Also available in stainless steel.
- ② Complete model number by inserting value of radius (R) in mm.

Mounting Brackets.

Sold in sets of two.

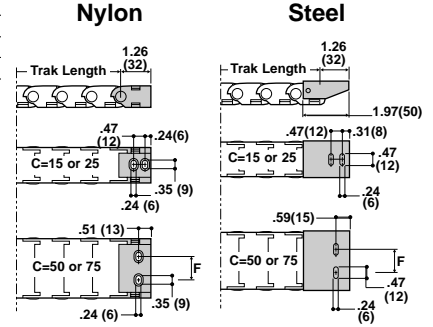

Carrier part number	Radius R** in (mm)	Curve Length M** in (mm)	O.A. Height H** in (mm)	Outside Width A in (mm)	Outside Height B in (mm)	Inside Width C in (mm)	Inside Height D in (mm)	Weight lb/ft (kg/m)	Nylon Bracket F in (mm)	Steel Bracket F in (mm)
SR305A008	1.97 (050)	9.06 (230)	5.12 (130)	2.13 (54)	1.18 (30)	1.18 (30)	0.94 (24)	0.57 (0.85)	1.69 (43)	1.22 (31)
SR305A010	2.76 (070)	11.42(290)	6.69 (170)	2.13 (54)	1.18 (30)	1.18 (30)	0.94 (24)	0.57 (0.85)	1.69 (43)	1.22 (31)
SR305A020	4.72 (120)	17.72(450)	10.63(270)	2.13 (54)	1.18 (30)	1.18 (30)	0.94 (24)	0.57 (0.85)	1.69 (43)	1.22 (31)
SR305A050	5.91 (150)	21.46(545)	12.99(330)	2.13 (54)	1.18 (30)	1.18 (30)	0.94 (24)	0.57 (0.85)	1.69 (43)	1.22 (31)
SR305A009	1.97 (050)	9.06 (230)	5.12 (130)	2.91 (74)	1.18 (30)	1.97 (50)	0.94 (24)	0.64 (0.95)	2.48 (63)	2.01 (51)
SR305A030	2.76 (070)	11.42(290)	6.69 (170)	2.91 (74)	1.18 (30)	1.97 (50)	0.94 (24)	0.64 (0.95)	2.48 (63)	2.01 (51)
SR305A040	4.72 (120)	17.72(450)	10.63(270)	2.91 (74)	1.18 (30)	1.97 (50)	0.94 (24)	0.64 (0.95)	2.48 (63)	2.01 (51)
SR305A060	5.91 (150)	21.46(545)	12.99(330)	2.91 (74)	1.18 (30)	1.97 (50)	0.94 (24)	0.64 (0.95)	2.48 (63)	2.01 (51)

* Refer to diagram on back page.

Technical characteristics when self-supported	Separator	Pin	Pin Removal Tool
Speed 32.81 ft/s (10 m/s)	Unassembled p/n S305	Part no. PG305	Part no. PZ010
Acceleration 164.04 ft/s ² (50 m/s ²)	Assembled p/n S305MC		
Pitch 1.38 in. (35 mm)			

End Brackets	Nylon p/n	Steel p/n
Complete set, assembled	Nylon p/n AN305KM	Zinc Plated Steel①, 2.13" wide, p/n AP305AKM1
Complete set, unassembled	Nylon p/n AN305K	Zinc Plated Steel①, 2.91" wide, p/n AG305AKM1
		Zinc Plated Steel①, 2.13" wide, p/n AP305AK1
		Zinc Plated Steel①, 2.91" wide, p/n AG305AK1

- ① Also available in stainless steel.

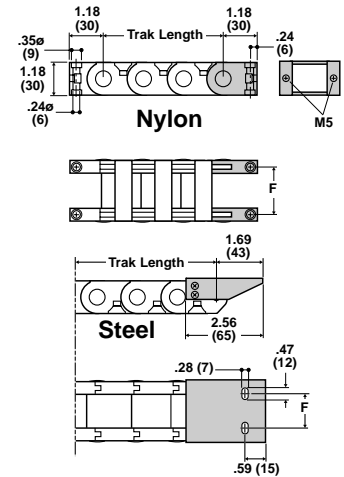

Carrier part number	Radius R** in (mm)	Curve Length M** in (mm)	O.A. Height H** in (mm)	Outside Width A in (mm)	Outside Height B in (mm)	Inside Width C in (mm)	Inside Height D in (mm)	Weight lb/ft (kg/m)	Nylon Bracket F in (mm)	Steel Bracket F in (mm)
SR355A045	2.95 (075)	12.40 (315)	7.60 (193)	2.91 (74)	1.69 (43)	1.77 (45)	1.22 (31)	0.94 (1.40)	2.32 (59)	1.97 (50)
SR355A046	3.94 (100)	15.55 (395)	9.57 (243)	2.91 (74)	1.69 (43)	1.77 (45)	1.22 (31)	0.94 (1.40)	2.32 (59)	1.97 (50)
SR355A047	5.91 (150)	21.85 (555)	13.50(343)	2.91 (74)	1.69 (43)	1.77 (45)	1.22 (31)	0.94 (1.40)	2.32 (59)	1.97 (50)
SR355A048	7.87 (200)	27.95 (710)	17.44(443)	2.91 (74)	1.69 (43)	1.77 (45)	1.22 (31)	0.94 (1.40)	2.32 (59)	1.97 (50)
SR355A065	2.95 (075)	12.40 (315)	7.60 (193)	3.70 (94)	1.69 (43)	2.56 (65)	1.22 (31)	1.01 (1.50)	3.11 (79)	2.76 (70)
SR355A066	3.94 (100)	15.55 (395)	9.57 (243)	3.70 (94)	1.69 (43)	2.56 (65)	1.22 (31)	1.01 (1.50)	3.11 (79)	2.76 (70)
SR355A067	5.91 (150)	21.85 (555)	13.50(343)	3.70 (94)	1.69 (43)	2.56 (65)	1.22 (31)	1.01 (1.50)	3.11 (79)	2.76 (70)
SR355A068	7.87 (200)	27.95 (710)	17.44(443)	3.70 (94)	1.69 (43)	2.56 (65)	1.22 (31)	1.01 (1.50)	3.11 (79)	2.76 (70)
SR355A095	2.95 (075)	12.40 (315)	7.60 (193)	4.88(124)	1.69 (43)	3.74 (95)	1.22 (31)	1.14 (1.70)	4.29(109)	3.94(100)
SR355A096	3.94 (100)	15.55 (395)	9.57 (243)	4.88(124)	1.69 (43)	3.74 (95)	1.22 (31)	1.14 (1.70)	4.29(109)	3.94(100)
SR355A097	5.91 (150)	24.85 (555)	13.50(343)	4.88(124)	1.69 (43)	3.74 (95)	1.22 (31)	1.14 (1.70)	4.29(109)	3.94(100)
SR355A098	7.87 (200)	27.95 (710)	17.44(443)	4.88(124)	1.69 (43)	3.74 (95)	1.22 (31)	1.14 (1.70)	4.29(109)	3.94(100)

* Refer to diagram on back page.

Technical characteristics when self-supported	Separator	Pin	Pin Removal Tool
Speed 32.81 ft/s (10 m/s)	Unassembled p/n S355	Part no. PG355	Part no. PZ010
Acceleration 164.04 ft/s ² (50 m/s ²)	Assembled p/n S355MC		
Pitch 1.57 in. (40 mm)			

End Brackets	Nylon p/n	Steel p/n
Complete set, assembled	Nylon p/n AN355KM	Zinc Plated Steel①, 2.91" wide, p/n AP355AKM1
Complete set, unassembled	Nylon p/n AN355K	Zinc Plated Steel①, 3.70" wide, p/n AM355AKM1
		Zinc Plated Steel①, 4.88" wide, p/n AG355AKM1
		Zinc Plated Steel①, 2.91" wide, p/n AP355AK1
		Zinc Plated Steel①, 3.70" wide, p/n AM355AK1
		Zinc Plated Steel①, 4.88" wide, p/n AG355AK1

- ① Also available in stainless steel.

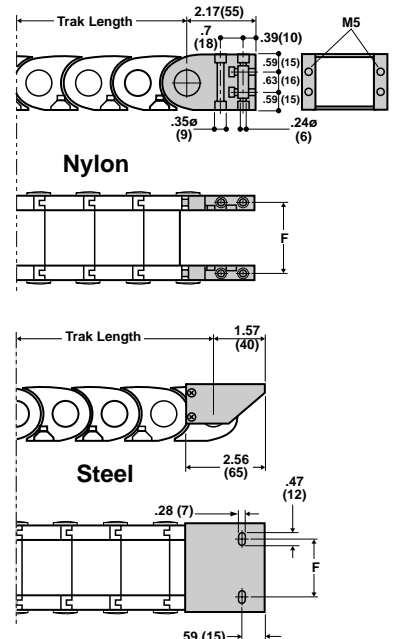

MEDIUM SERIES

SR400

Molded nylon links with antifriction pivots. Enclosed on outer radius. Snap fit bars removable from inner radius to facilitate cable installation. Movable separators can be installed to create different compartments. Carrier length can be easily field customized.

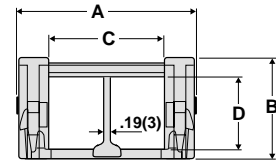

Mounting Brackets.

Sold in sets of two.

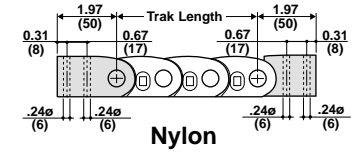

Nylon

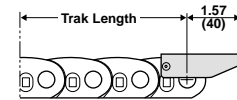
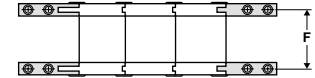

Steel

Carrier part number	Radius R* in (mm)	Curve Length M* in (mm)	O.A. Height H* in (mm)	Outside Width A in (mm)	Outside Height B in (mm)	Inside Width C in (mm)	Inside Height D in (mm)	Weight lb/ft (kg/m)	Nylon Bracket F in (mm)	Steel Bracket F in (mm)
SR400040	1.97 (050)	9.45 (240)	5.31 (135)	2.44 (62)	1.38 (35)	1.57 (40)	0.98 (25)	0.74 (1.10)	1.97 (50)	1.18 (30)
SR400041	2.95 (075)	12.40(315)	7.28 (185)	2.44 (62)	1.38 (35)	1.57 (40)	0.98 (25)	0.74 (1.10)	1.97 (50)	1.18 (30)
SR400042	3.94 (100)	15.55(395)	9.25 (235)	2.44 (62)	1.38 (35)	1.57 (40)	0.98 (25)	0.74 (1.10)	1.97 (50)	1.18 (30)
SR400043	5.91 (150)	21.85(555)	13.19(335)	2.44 (62)	1.38 (35)	1.57 (40)	0.98 (25)	0.74 (1.10)	1.97 (50)	1.18 (30)
SR400060	1.97 (050)	9.45 (240)	5.31 (135)	3.23 (82)	1.38 (35)	2.36 (60)	0.98 (25)	0.84 (1.25)	2.76 (70)	1.97 (50)
SR400061	2.95 (075)	12.40(315)	7.28 (185)	3.23 (82)	1.38 (35)	2.36 (60)	0.98 (25)	0.84 (1.25)	2.76 (70)	1.97 (50)
SR400062	3.94 (100)	15.55(395)	9.25 (235)	3.23 (82)	1.38 (35)	2.36 (60)	0.98 (25)	0.84 (1.25)	2.76 (70)	1.97 (50)
SR400063	5.91 (150)	21.85(555)	13.19(335)	3.23 (82)	1.38 (35)	2.36 (60)	0.98 (25)	0.84 (1.25)	2.76 (70)	1.97 (50)

* Refer to diagram below.

Technical characteristics when self-supported

Speed	32.81 ft/s	(10 m/s)
Acceleration	164.04 ft/s ²	(50 m/s ²)
Pitch	1.57 in.	(40 mm)

Separator

Unassembled p/n S400
Assembled p/n S400MC

Pin

Part no. PG305

Pin Removal Tool

Part no. PZ010

Mounting Brackets

Complete set, assembled	Nylon p/n AN400KM	Zinc Plated Steel ^① , 2.44" wide, p/n AP400KM1
		Zinc Plated Steel ^① , 3.23" wide, p/n AG400KM1
Complete set, unassembled	Nylon p/n AN400K	Zinc Plated Steel ^① , 2.44" wide, p/n AP400K1
		Zinc Plated Steel ^① , 3.23" wide, p/n AG400K1

① Also available in stainless steel.

Chain Length Diagram (applies to all models)

Chain length required equals 1/2 total travel plus length of curve (M)

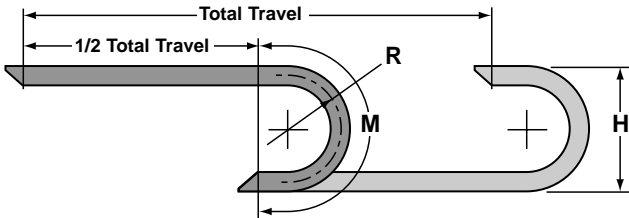

Ways of Mounting End Brackets

Use this diagram if mounting bracket position must be included in model number.

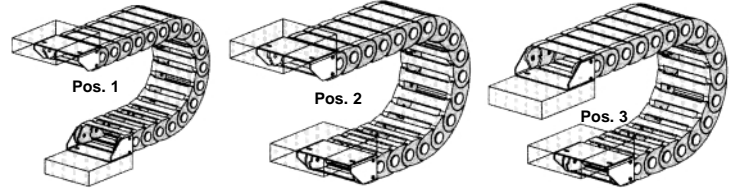

For slightly larger cable carriers, see Medium Series SR435 through SR770A.
Ask your Gleason Representative about the full cable carrier line.

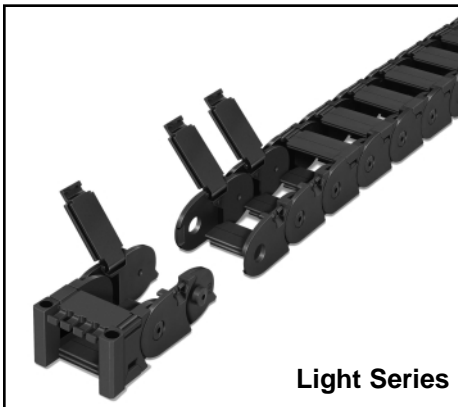

Light Series

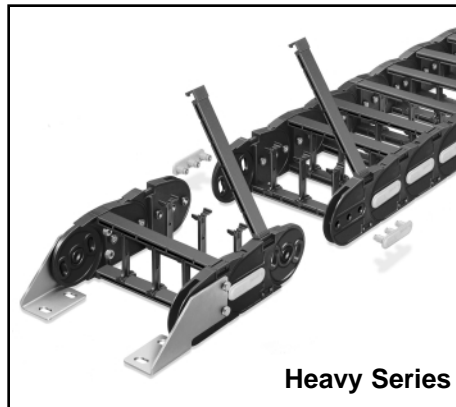

Heavy Series



Protection Series



Gleason Reel Corp.

600 South Clark Street
P.O. Box 26
Mayville, WI 53050
Phone: 920-387-4120 Fax: 920-387-4189
www.hubbell-gleason.com